

# SmartView Pocket

## User Manual Guide d'utilisation



**This document will show you how to use your SmartView Pocket's many features.**

## **1. Contents of the Package**

- Handheld video magnifier**
- Power supply**
- USB cable**
- RCA video cable**
- Protective case**
- Carrying strap**
- Cleaning cloth**
- User Guide**
- Warranty Card**

## 2. SmartView Pocket's features location

- 1: Power button
- 2: Reset button
- 3: Light button
- 4: Freeze image button
- 5: Power light
- 6: Charge light
- 7: Increase (+) button
- 8: Decrease (-) button
- 9: Settings button
- 10: Mode button
- 11: USB port
- 12: A/V port



### 3. Using the SmartView Pocket

#### 3.1 Positioning the SmartView Pocket's stand

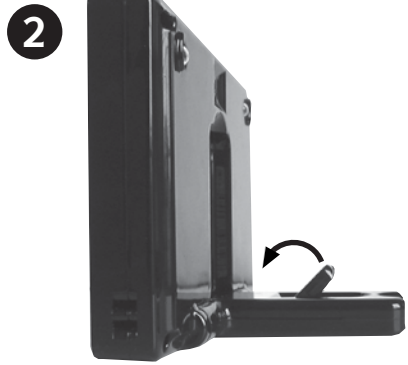
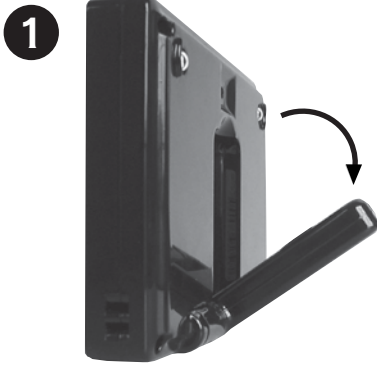

## 3.2 Reading and writing positions



### 3.3 Key Description

<b>Key</b>	<b>Function</b>
<b>Power</b>	Used to power on/off.
<b>Reset</b>	Only use if the SmartView Pocket stops responding. Press Power to restart.
<b>Light</b>	Turn on/off light that illuminates viewing surface.
<b>Freeze</b>	Freeze an image.
<b>Settings</b>	Zoom / Brightness / Environment / Sound. Selected Setting can be modified with Increase (+) and Decrease (-) buttons. Setting will remain on current value until pressed again. Leave setting in Zoom for normal operation.
<b>Mode</b>	Image mode toggle: Color / Gray / Negative / Positive
<b>Increase (+)</b>	Used to change the selected setting.
<b>Decrease (-)</b>	Used to change the selected setting.

### **3.4 Recharging the Battery**

**To recharge the SmartView Pocket:**

- Connect the power supply to one end of the USB cable.**
- Connect the other end of the USB connector to the SmartView Pocket's USB port.**
- Plug the power supply to an electrical outlet.**

**The SmartView Pocket needs to be plugged in for approximately 3 hours to reach full charge. The charger light will turn off when fully charged.**

**Once fully charged, the SmartView Pocket can be used for a period of about 3 hours.**

### **3.5 Connecting to a TV screen**

**If you wish to view the magnified image on a larger screen, you can connect the SmartView Pocket to a television. To do so, plug the RCA video cable's single connector to the SmartView Pocket's A/V port located on the left edge. Plug the yellow (video) connector to video input port on your television. The remaining sound connectors are not used.**

**Warning: Avoid exposure to moisture, rain, sand and extreme temperatures**