

## 'Tuffy' TITAN Utility & Audio Visual Carts 27"D x 32"W



WTVW54E



WTVW44E

← **Top Shelves Will Hold Most 32" TV's!**

**Three Shelf Models Hold Up To 400 LBS Of Evenly Distributed Weight!**



WTVW34E

### Tuffy WTVW Widebase Carts

- ⇒ The **exclusive curved leg design** of these carts enhances stability while accommodating larger equipment.
- ⇒ WTVW carts have a top shelf that is 24"D x 32"W. The middle and bottom shelves measure 27"D x 32"W.
- ⇒ Constructed from an engineered thermoplastic resin, injection molded, that will not chip, warp, crack, rust, or peel.
- ⇒ There are two steel reinforcements molded into the 2" thick top shelf for extra strength. Legs are 2" square.
- ⇒ Tuffy shelves have a ¼" safety retaining lip and raised texture surface that enhances product placement and ensures minimal sliding.
- ⇒ Included with every Tuffy video cart is a 3-outlet UL approved electrical assembly with a 15 ft. cord, cord management wrap, and three cable management clips.
- ⇒ Electrical attachment is recessed to insure easy passage through doorways and other tight spots.
- ⇒ Four 4" silent-roll, full swivel, ball bearing casters, two with locks, max. weight rated at 125 lbs. each.
- ⇒ Shelves and legs are made from recyclable material.

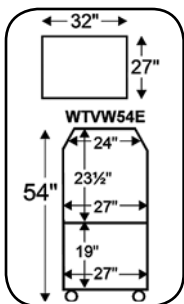

WTVW Cart Dimensions



**ERS** - Details On Page 52  
**M.S.R.P. - \$50.00**



**ESS** - Details On Page 52  
**M.S.R.P. - \$20.00**



**EHS** - Details On Page 52  
**M.S.R.P. - \$50.00**

MODEL	COLOR	SHELVES	HEIGHT	WEIGHT	M.S.R.P.
WTVW34E	BLACK	2	34"	45 LBS.	\$383.00
WTVW44E	BLACK	3	44"	66 LBS.	\$545.00
WTVW48E	BLACK	3	48"	67 LBS.	\$553.00
WTVW54E	BLACK	3	54"	68 LBS.	\$567.00



**Cabinet Model 'Tuffy' TITAN Utility & Audio Visual Carts 27"D x 32"W**



WTVW48CE



WTVW54CE

Top Shelves Will Hold Most 32" TV's!

**Tuffy WTVW Cabinet Carts Include ALL The Great Features Of The WTVW Open Shelf Carts On Page 18 PLUS**

**WTVW Cabinet Features**

- ⇒ Cabinets are made of 20 gauge steel.
- ⇒ Includes a lock with a set of two keys and recessed chrome handles on each door.
- ⇒ Back panel has cable management access.

**Widebase Design Enhances Stability!**  
**XL Locking Cabinet For Lots Of Storage Space AND Security!**

Side View



WTVW44CE

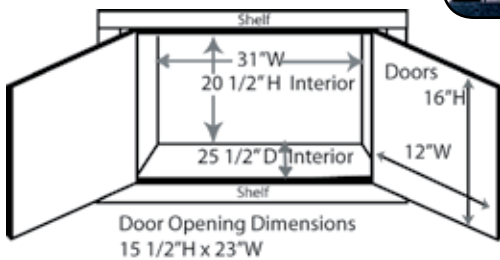

MODEL	COLOR	SHELVES	HEIGHT	CABINET	WEIGHT	M.S.R.P.
WTVW44CE	BLACK	3	44"	Y	106 LBS.	\$945.00
WTVW48CE	BLACK	3	48"	Y	106 LBS.	\$957.00
WTVW54CE	BLACK	3	54"	Y	107 LBS.	\$970.00



**TITAN Video Carts**