



This manual has been prepared for the owners and operators of the ARMEDICA™ AM-700 Series Parallel Bars and contains installation instructions, precautionary instructions and maintenance procedures for the following model numbers:

**AM-700, AM-702, AM-703,
AM-705, AM-706, AM-706HD**



This User's Manual is for the following AM-700 series Parallel platforms only

AM-700 - Electric platform mount 10'x43"

AM-702 - Electric platform mount 7'x43"

AM-703 - Electric platform mount 15'x43"

AM-705 - Electric bariatric platform mount 10'x49-1/2"

AM-706 - Electric bariatric platform mount 10'X49-1/2"

AM-706HD - Electric bariatric platform mount 10'x49-1/2" with 11GA. hand rails



WARNING: Read and understand this user's manual before installing or using this equipment.
Failure to follow operating and maintenance instructions could result in equipment damage or personal injury.



IMPORTANT: Do not use this manual to reference instructions, requirements or specifications for any product other than those listed in this manual.
Equipment damage, void of warranty and personal injury may occur.

Table of Contents

Models covered in manual and table of contents	2
Symbols and Indicators	3
Definitions	4
Assembly and Installation	6
Operating instructions	9
Maintenance	10
Cleaning	11
Technical specifications	12
Parts list and Drawings	13
Maintenance Log	23
Warranty information	24

SYMBOLS and INDICATORS



WARNING: Read and understand the operating instructions listed in this manual before installing or using this equipment.
Failure to follow manufacturer's operating instructions could result in equipment damage or personal injury.



ATTENTION: Important information or instructions.



WARNING: Follow safe lifting procedures and precautions.

WARNING: Identifies electrical shock hazard.



Type B Applied part: An Applied Part complying with the specified requirements to provide protection against electric shock, particularly regarding allowable patient leakage current and patient auxiliary current.



No. 5019

This platform is equipped with a protective earth ground. This device may only be connected to a power source with a protectively earthed ground.



Alternating Current

DEFINITIONS

The AM-700 Series Electric Parallel Bars are a Class 1 medical device in respect to the use of an earthed ground as a means of protection against electric shock.

Intended use: The AM-700 Series Electric Parallel Bars is intended for medical rehabilitation purposes and, to be used in conjunction with other forms of exercise, as a stability aid in standing, walking and balance exercises.



CAUTION: Using this device in a manor inconsistent with its labeling will void warranty and, damage to device or personal injury may occur.



CAUTION: This device is not suitable for use in an oxygen rich environment or in the presence of flammable anesthetics. Fire or explosion may occur.

Patient: Any person cleared by a doctor or physical therapist currently using this device as an exercise platform under the direction and supervision of a qualified operator.

Operator: Any person/persons who is a professionally trained and certified physical therapist and authorized by the consumer or responsible organization to operate this platform. Specific instructions for operation of the AM-700 series can be found in this manual. If further training on the operation of the AM-700 is required, it is available by contacting Armedica Mfg. customer service.



CAUTION: A patient is not intended to operate this device in any way. The AM-700 series Electric Parallel Bars shall be operated by trained, qualified and authorized personnel ONLY.

Service Technician: Any person/persons authorized by Armedica Manufacturing to perform service, component replacement or repair to the AM-700 Series Electric Parallel Bars.

DEFINITIONS CONTINUED

Duty Cycle: The ratio of time the device can be in a state of continuous actuation (moving) and rest. Noted in units of minutes as ON/OFF. The Duty Cycle of this device is rated for 1(one) minute on / 9(nine) minutes off.

Electrical power source: This platform is intended to be connected to an external 120V \sim , 8 Amp (peak), 60Hz electrical power source.



WARNING: To avoid risk of electrical shock, this device must only be connected to a supply mains with protective earth ground.

Applied part: An applied part is one specifically intended to come into direct contact with patient during normal use. This includes Armedica part #'s 18628, 28320, 18627, 14601, 14605, 14609, 14610 and 14615 only. Applied parts are identified, either in this manual or directly on the part, with this symbol .

Accessible Part: An Accessible Part is any part that the patient or operator may come into direct contact with, either intentional or unintentionally, but direct contact is not required for normal operation.

Operator Interface: The point in which the operator will input data, via momentary push button, for actuation, memory function and device control.

AM SERIES ELECTRIC PARALLEL BARS



WARNING: Read and understand this operator's manual before installing or using this equipment. Failure to follow operating and maintenance instructions could result in equipment damage or personal injury.

ELECTRIC PARALLEL BARS INSTALLATION

ALL MODELS



WARNING: 4 people are required to move this equipment. This unit weighs in excess of 500lbs/1100kg. Failure to follow safe lifting instructions can result in serious personal injury and/or damage to equipment.



CAUTION: Do not lift or support by end ramps or columns. Damage or serious personal injury may occur

CAUTION: There are no contradictions associated with this device. The emissions characteristics of this device make it suitable for use in industrial areas and hospitals.

1. Remove platform (item # 1, 46, 47 or 51) from crate using handles attached to mounting brackets. Set the platform on firm level floor.
For 2-piece split platforms, set both pieces on side against a solid surface while installing connecting plates (50). Align the 2 pieces and firmly hold together. Using screws (49), install all connecting plates in recessed pockets. After all, connecting plates have been installed, place platform on floor as directed in step 1.
2. Place the four upright columns (13) between the brackets on the platform according to letter designations and tighten the mounting bolts (10) securely.
3. Install the hand rails  (30, 44 or 45) onto the adjustment tubes (4) using spacer (31), washers x2 (32), and lock nut (35); tighten the lock nut (35), sufficiently, to eliminate any play but not so tight that they will not pivot when adjusting the width. When necessary, adjust the width according to the operating instructions.
4. Remove the cover plate from box (23) to allow access to inside of control stand (20). Using nuts (21), mount the control stand (20) to the platform, threading AC mains cable, 4 protective earth ground wires (green with yellow), and connector cables (36, 37 and 42) through appropriate holes. Ensure all protective earth grounds are secured on the bolt pin with paint removed.
5. With screws (26) and cover plate (24) removed, connect the controller (22) per the following instructions.

SCU CONTROLLER

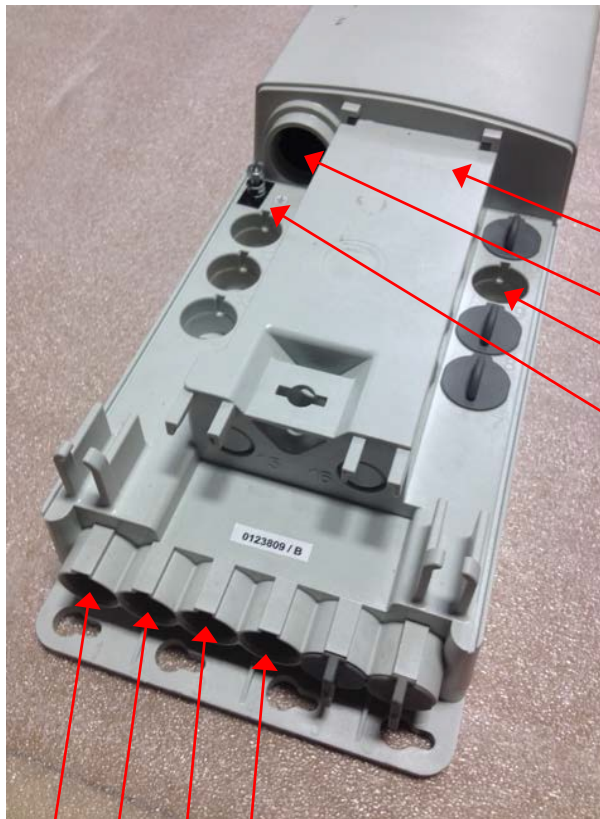

5 6 7 8

1
2
3
4

1. SCU CONTROLLER
2. AC MAINS PORT
3. SWITCH PORT
4. PROTECTIVE EARTH TERMINAL
5. MOTOR PORT M1
6. MOTOR PORT M2
7. MOTOR PORT M3
8. MOTOR PORT M4



CAUTION: All cables must be fully inserted into their appropriate receptacles on control box and columns. Failure to do so may cause unit malfunction and/or permanent damage to equipment.

WARNING: Dangerous voltage present.
Do not connect this unit to a power source before reading these instructions. Damage to equipment and/or electrical shock may occur.

WARNING: This device may only be used in a professional healthcare facility where operators with professional medical training are continuously available when patients are present.

WARNING: Do not adjust or operate this device while patient is on or using this device. Serious personal injury and/or damage to equipment may occur.

CABLE CONNECTIONS

- Connect the four cables (36) and (37) (DIN8 connectors) to the appropriate column (13).
- Remove cover from the lower section of the SCU controller by rotating the lock screw, located on the front of the cover, to the “UNLOCK” position. Slide cover down to remove.

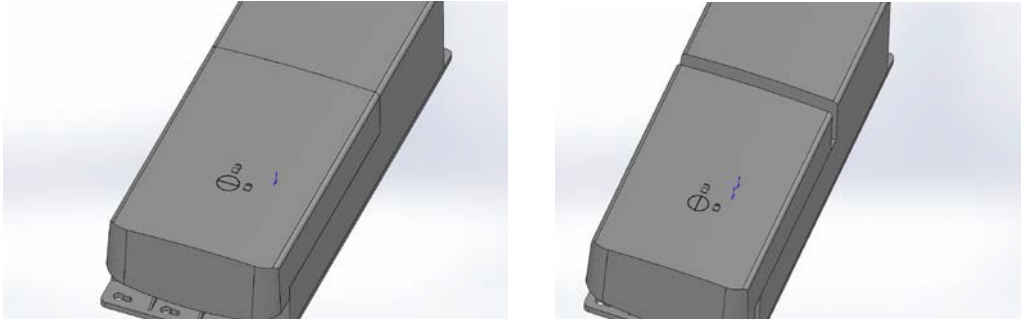

- Connect the four cables (36) and (37) (DIN8 connectors) to corresponding SCU controller motor ports M1, M2, M3 and M4 (AS LABELED)
- Verify that the control switch (27) cable with a blue DIN7 socket marked with a blue “HS” is securely connected in the switch port
- Securely connect the AC mains cable (42) into the AC mains port of the SCU controller.
- Verify that the required supply voltage indicated in this manual and on the name plate corresponds with the supply voltage of the electrical outlet and connect the unit to the electrical outlet. *See Technical Data section for a full list of operating conditions and requirements.*



CAUTION: This device is rated for 120 volts 60Hz, 6.5Amps/8Amps peak. Protective earth ground required.

ATTENTION: Allow 10 seconds, after connecting to power supply, for system to fully initialize and display reads “028” before attempting any operations. See figure below.



ELECTRIC PARALLEL BARS OPERATING INSTRUCTIONS

ALL MODELS

INTENDED POSITIONS

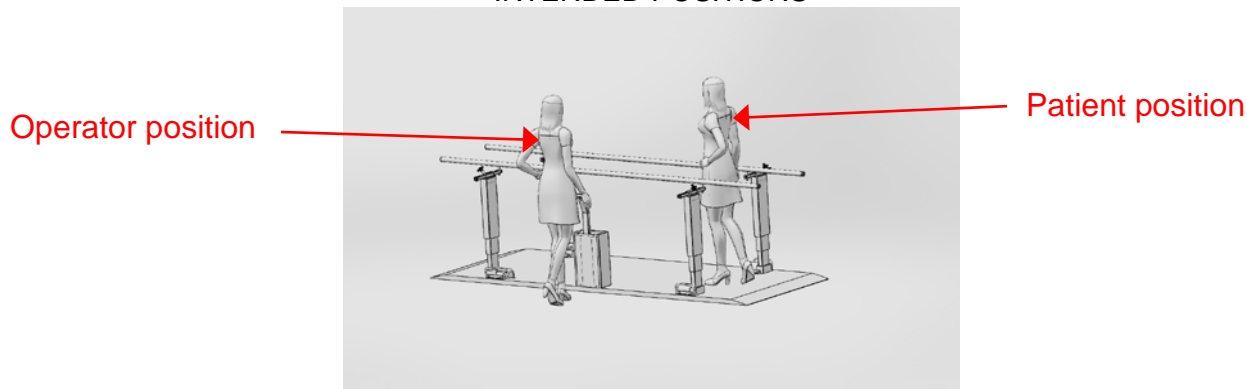

This unit has been initialized by Armedica Manufacturing Corp. prior to shipment and should not need to be synchronized again unless a column or control box is replaced.

If Synchronization becomes necessary, follow these steps:

INITIAL RESET FOR MOTORS

- After you have connected the control units to the power supply for the first time, the network is addressed, and motors must be synced. This is indicated by "---" remaining on the display after approximately 10 seconds.
- Press and hold 1+2+UP BUTTON for 5-10 seconds then you will hear a audible click, then beeps. Release buttons, beep stops.
- Press and HOLD the down ARROW key. All 4 columns should lower at a reduced speed. Continue to hold the key until the columns reach their lowest point and, you hear an audible click. Wait three seconds and display should show the current height.

SETTING THE PARALLEL BAR HEIGHT

- Press the up arrow to raise the parallel bars.
- Press the down arrow to lower the parallel bars.
- The current height of the bars appears (in inches) on the display.

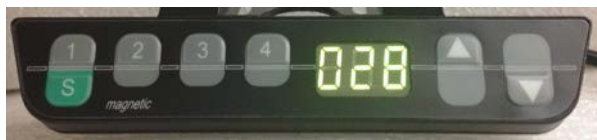

WARNING: Ensure platform is clear and, there are no obstructions under the handrails before actuating the columns to adjust height. Serious personal injury and/or damage to equipment may occur.

SAVING THE MEMORY POSITIONS

This function makes it possible to save a predetermined height setting. Four different heights may be saved. These saved positions can be used later.

- Adjust the bars to desired height by using the UP or Down arrow keys.
- Press the green memory key (S) and release. Press the desired memory key (1, 2, 3 or 4). An audible click signals the position is now saved to that number.

USING THE MEMORY POSITIONS

- While holding down the desired memory position button, the bars will move toward the predefined position and stop.

ADJUSTING THE WIDTH OF THE PARALLEL BARS

- Turn hand knobs, on top of each column, to release adjusting tubes and set to desired width.
- Make sure adjusting tube knobs are securely tightened before use.

MAINTENANCE



CAUTION: Failure to follow recommended maintenance instructions may cause damage to equipment, personal injury and void warranty.

ARMEDICA™ Manufacturing thoroughly inspects and tests each unit to ensure that it meets all ARMEDICA™ quality standards before it leaves the facility. To ensure the longevity of your device, routine maintenance should be followed.

AFTER FIRST 40 HOURS OF SERVICE

- ✓ Physically inspect all fasteners and hardware are properly secured

DAILY / Pre-USE

The operator should visually inspect the unit prior to each use for;

- ✓ Foreign objects that may interfere with operation or create a hazard to patient
- ✓ Signs of damage to unit and power cord
- ✓ All hardware (nuts, bolts, etc.) is present and properly secured
- ✓ All adjustments are secure
- ✓ Unit functions properly

CLEANING

- Use towel dampened with mild soap and water. Wipe down to remove dust, dirt and spills. Wipe with dry towel to remove moisture
 - ✓ Laminated platform
 - ✓ Painted, plated and plastic surfaces
- Use a commercial brand stainless steel cleaner to remove dirt and oil from hand rails
- The laminated platform and painted or plated components should be cleaned with a commercial disinfectant and wiped with a dry cloth to remove any biological contamination when necessary.



WARNING: This unit is not rated for wash down, it should not be exposed to standing or quantities of liquid. Do not clean any electronic device with water. Electrical shock and/or damage to electronics may occur.

TROUBLE SHOOTING

In the event it becomes necessary to replace the control box or a column on the AM-700 series, disconnect power prior to removal, and make certain the plugs are completely inserted into the sockets prior to reconnecting power.



ATTENTION: The AC Mains Cable serves as the
EMERGENCY DISCONNECT DEVICE

Do not position this device in a manner that would make it difficult to reach the AC mains supply cable. In the event of an emergency, unplug the AC Mains Cable from the external power supply.



WARNING: Disconnect main power to unit before opening control stand and checking cables. Electrical shock and/or damage to electronics may occur.

ELECTRIC POWERED COLUMNS DO NOT WORK.

- A. Verify that proper voltage at electrical outlet and cord is plugged in.
- B. Verify all cables inside the control stand and motor columns are securely plugged into their proper receptacles.
- C. Verify the hand switch cable is securely plugged into the proper control unit.

If problem still occurs, or columns become unsynchronized, please contact Armedica Manufacturing Customer Service.



CAUTION: Service to controls and column motors is to be done by the manufacturer only. In the event of a column motor or control unit failure, all 4 columns and control unit must be returned to Armedica Manufacturing Corp.



WARNING: Do not alter or modify this device in any way. Altering this device will void all warranties. Serious personal injury and/or damage to equipment may occur.



WARNING: Use only replacement parts approved by Armedica Manufacturing. Failure to do so could result in damage to device, increased emissions, immunity/susceptibility to such and serious injury. A list of specific authorized replacement parts, including cables and other critical components, is provided on page 15 of this manual.

TECHNICAL SPECIFICATIONS

ENVIROMENTAL CONDITIONS

Operating/storage temp. 5°C – 40°C / 41°F – 104°F

Humidity: 5% to 85%

Pressure/altitude: 700hPa to 1060hPa

GENERAL SPECIFICATIONS

Manufactured and assembled by

Armedica Manufacturing Corp.
Greenwood, Arkansas, USA
Tel.: (479) 996-2612

Static & Dynamic load capacity

Max 500Lbs/227Kgs per bar, not exceeding 500Lbs/227Kgs total combined load.



CAUTION: Do not exceed Maximum load capacity. Damage to unit and/or serious injury may occur. This device is not rated for a dynamic(moving) load. Do not use as a patient lift.



CAUTION: Do not throw in trash. Expected service life of this device is approximately 10 years. Dispose of this device in accordance with local, state and national environmental regulations. Failure to do so may constitute a criminal act.

ELECTRICAL SPECIFICATIONS

Main input power requirements 120VAC \sim 60Hz

Current 6.5Amps / 8Amps (peak)

Secondary output power 24VDC --- / 360V/A

Duty cycle 1min. on / 9min. off

Model SCU56-003230-000

Manufactured by:

SKF Actuation Systems

Oristalstrasse 97

CH-4410 Liestal

Tel.: +41/61/925 41 41

Email: actuators.switzerland@skf.com

ITEM NO.	PART NO.	DESCRIPTION	700	QUANTITY					706HD
				702	703	705	706	706HD	
1	14601	BD PLL COLMN PLATFORM LAMNTD	1	N/A	N/A	N/A	N/A	N/A	N/A
2	28156	PLATE 1/4x4-3/4x6-1/2 PLL COLMN MNT PLTD	4	4	4	4	4	4	4
3	03021	SCREW TAPTITE M6X25	16	16	16	16	16	16	16
4	11601	TUBE 1x1x14GAx13 PLL RAIL ATTACH	4	4	4	4	4	4	4
5	02146	SPACER 5/16 X 3/16 ID x 1/2 OD	4	4	4	4	4	4	4
6	02093	NUT NYLOCK 8-32	4	4	4	4	4	4	4
7	13601	ROD 1/2 DIAx.75 PLUNGER	4	4	4	4	4	4	4
8	03071	KNOB W/STEM 2-1/4x3/8-16x1	4	4	4	4	4	4	4
9	02033	NUT HEX M8-1.25Z	16	16	16	16	16	16	16
10	02031	SCREW HEX HD 8MM-1.25x14Z	16	16	16	16	16	16	16
11	03076	CAP PLAS BLK 5/16 HEX DOME	16	16	16	16	16	16	16
12	18593	BRKT PLL RAIL ADJ RT PLTD	2	2	2	2	2	2	2
13	03181	TMD PLL COLUMN ONLY	4	4	4	4	4	4	4
14	02105	NUT NYLOCK 5/16-18	16	16	16	16	16	16	16
15	28042	BRKT PLL COLUMN MNT W/HANDLE PLTD	4	4	4	4	4	4	4
16	12633	ANG 1x1x6-1/4 PLL CLMN MNT PLTD	4	4	4	4	4	4	4
17	18665	BUSH W/WASHER PLL PIN GUIDE PLTD	2	2	2	2	2	2	2
18	02063	SCREW HX WASHER HD #10x3/4	38	38	38	38	38	38	38
19	28040	BRKT PLL PLTFRM CONTROL STAND MNT	1	1	1	1	1	1	1
20	18672	TUBE PLL CTRL STAND S/A	1	1	1	1	1	1	1
21	02100	NUT NYLOCK 1/4-20	4	4	4	4	4	4	4
22	03556	CONTROL SCU PLL	1	1	1	1	1	1	1
23	03078	BOX 4-5/16x17x14GA SHT MTL PLL	1	1	1	1	1	1	1
24	03078	PLATE 8-1/4x16-15/16x14GA COVER SKF PLL	1	1	1	1	1	1	1
25	03080	RIV NUT 1/4-20 ALUMINUM 14GA	4	4	4	4	4	4	4
26	02538	SCREW BTN HD SOC 1/4-20x3/4	4	4	4	4	4	4	4
27	03183	SWITCH PLL TMD CONTROL	1	1	1	1	1	1	1
28	02040	NUT HX 5-40 MACH SCRW	3	3	3	3	3	3	3
29	18598	BRKT PLL RAIL ADJUST LEFT PLTD	2	2	2	2	2	2	2
30	18628	TUBE STAINLESS PLL RAIL S/A	2	N/A	N/A	2	2	2	2
31	13056	BUSHING 1/2IDx3/4ODx1-1/8 CNTRL BUSH	4	4	4	4	4	4	4
32	02165	WASHER NYLON 1/2 ID	8	8	8	8	8	8	8
33	03010	PLUG 1x1x14GA	8	8	8	8	8	8	8
34	03014	PLUG RD 1"ODx14-20 GA BLK	4	4	4	4	4	4	4
35	02095	NUT NYLOCK JAM 1/2-13	4	4	4	4	4	4	4
36	03184	CABLE TMD CONNECT LONG 8FT	2	2	2	2	2	2	2
37	03185	CABLE TMD CONNECT SHORT 4'-10"	2	2	2	2	2	2	2
38	02148	BUSHING INSUL NYLON PLL	4	4	4	4	4	4	4
39	03364	LD SWITCH ADAPTER	1	1	1	1	1	1	1
40	02107	SCREW PAN HD PHIL 8-32x3/4"	4	4	4	4	4	4	4
42	03365	CBL 3.6M MED UL PWR CORD SCU	1	1	1	1	1	1	1
43	02201	CLAMP CABLE 1/4 WHITE	30	30	30	30	30	30	30
44	18627	TUBE STAINLESS 15' PLL RAIL S/A	N/A	N/A	2	N/A	N/A	N/A	N/A
45	11607	TUBE SS PLL 1-1/2 DIAx14GAx7'-6"	N/A	2	N/A	N/A	N/A	N/A	N/A
46	14609	BD PLL 7FT COLMN PLTFRM LAMNT	N/A	1	N/A	N/A	N/A	N/A	N/A
47	14610	BD PLL 15' SPLIT PLATFORM LAMNT	N/A	N/A	1	N/A	N/A	N/A	N/A
48	02200	CLAMP CABLE 3/16 BLACK	N/A	N/A	12	N/A	N/A	N/A	N/A
49	02695	SCREW #14x1 FLT HD PHIL WD	N/A	N/A	16	20	20	20	20
50	12609	PLT 1/4x2x8 PLL SPLIT PLTFRM PNTD	N/A	N/A	4	5	5	5	5
51	14615	BD PLL 10' PLTFRM BARIAT SPLIT W/EC	N/A	N/A	N/A	N/A	1	1	1
52	14605	BD PLL COLMN PLATFORM BARIATRIC	N/A	N/A	N/A	1	N/A	N/A	N/A
53	28320	TUBE STNLSS PLL 10' HD	N/A	N/A	N/A	N/A	N/A	2	2
54	02681	SCREW PAN HD PHIL 10-32x3/4	4	4	4	4	4	4	4
55	02144	WASHER FLAT #10	4	4	4	4	4	4	4
56	03554	WIRE 74" PE GRND PLL COLUMN ASM	2	2	2	2	2	2	2
57	03555	WIRE 48" PE GRND PLL COLUMN ASM	2	2	2	2	2	2	2
58	02078	SCREW PAN HD PHIL 10-32x3/8	4	4	4	4	4	4	4
59	02493	TERM RING INSUL #10 STUD 22-18 AWG	4	4	4	4	4	4	4

AM-700 SERIES DIMENSIONS & ADJUSTMENT SPECIFICATIONS

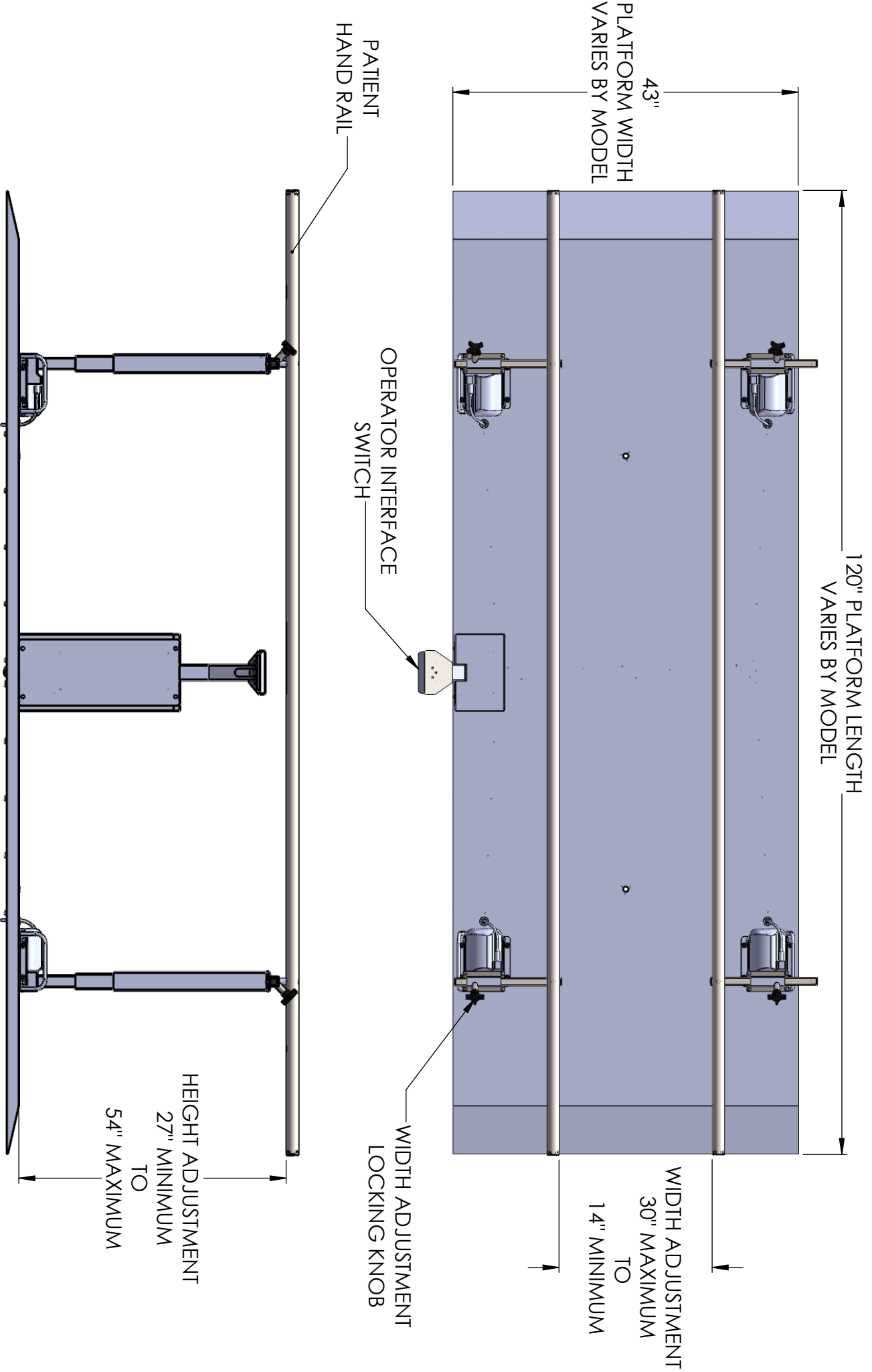

AM-700 SERIES ELECTRIC PARALLEL BARS

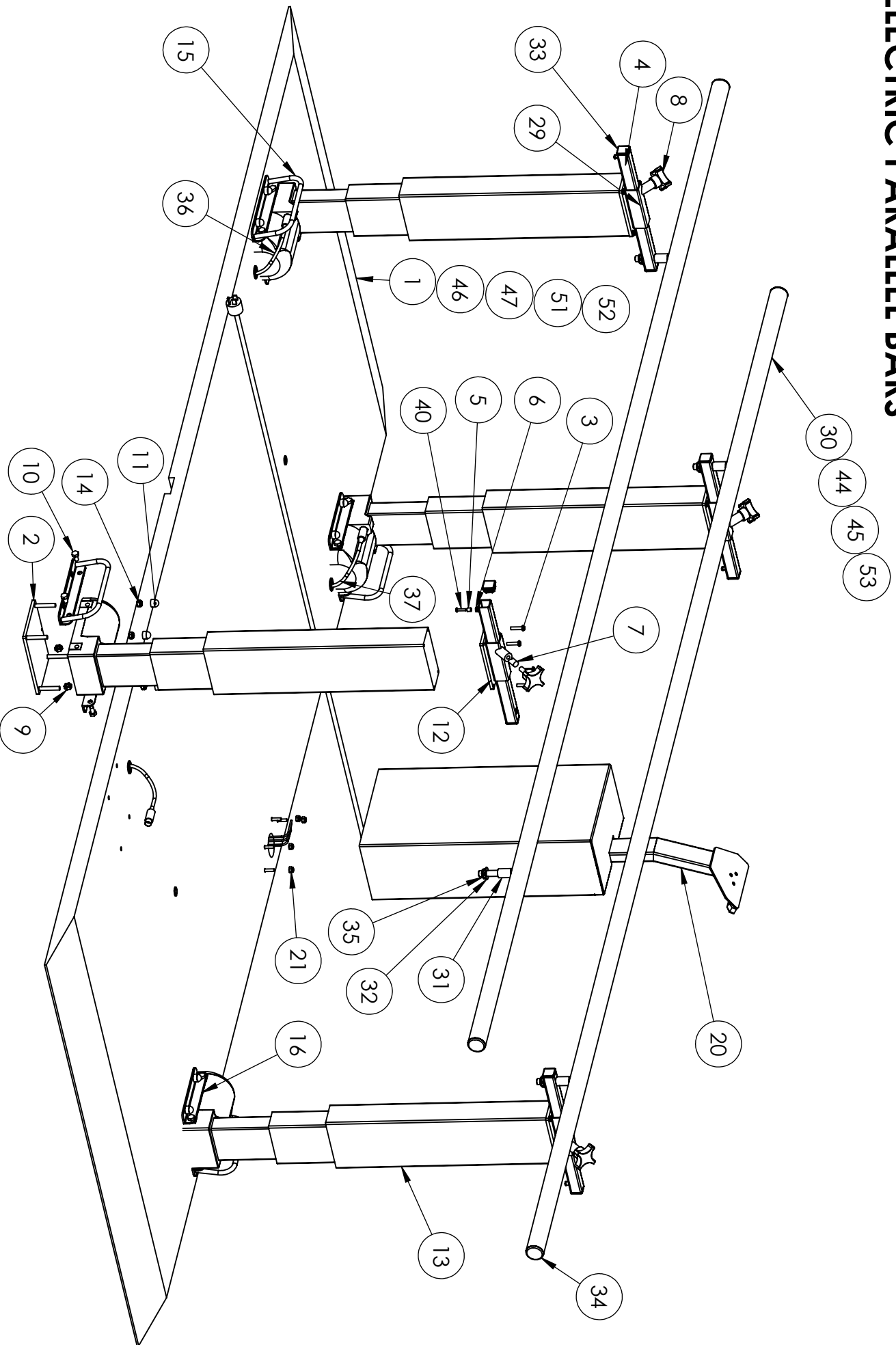

AM-700 SERIES ELECTRIC PARALLEL BARS BOTTOM VIEW

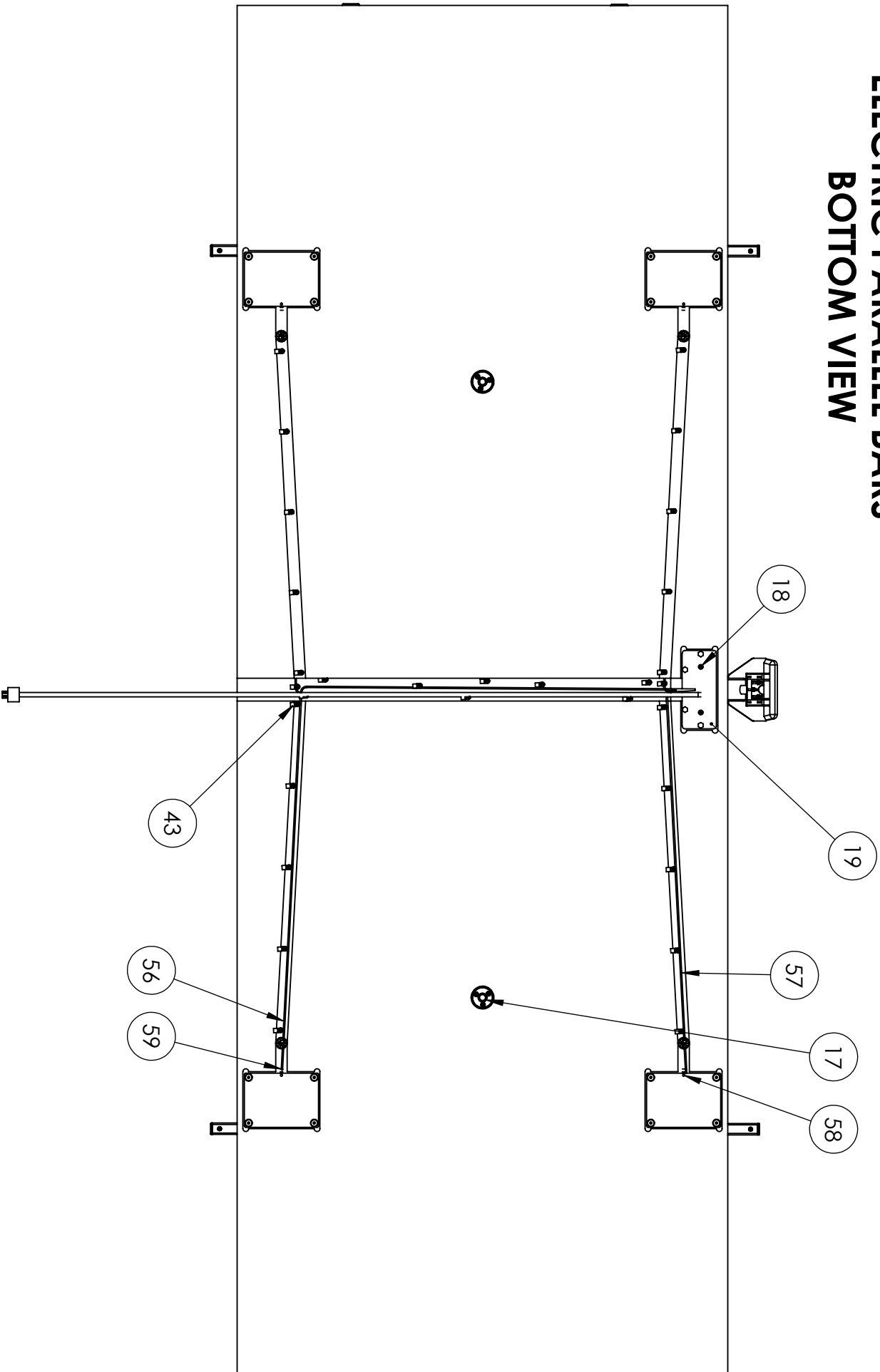

AM-700 SERIES ELECTRIC CONTROL STAND

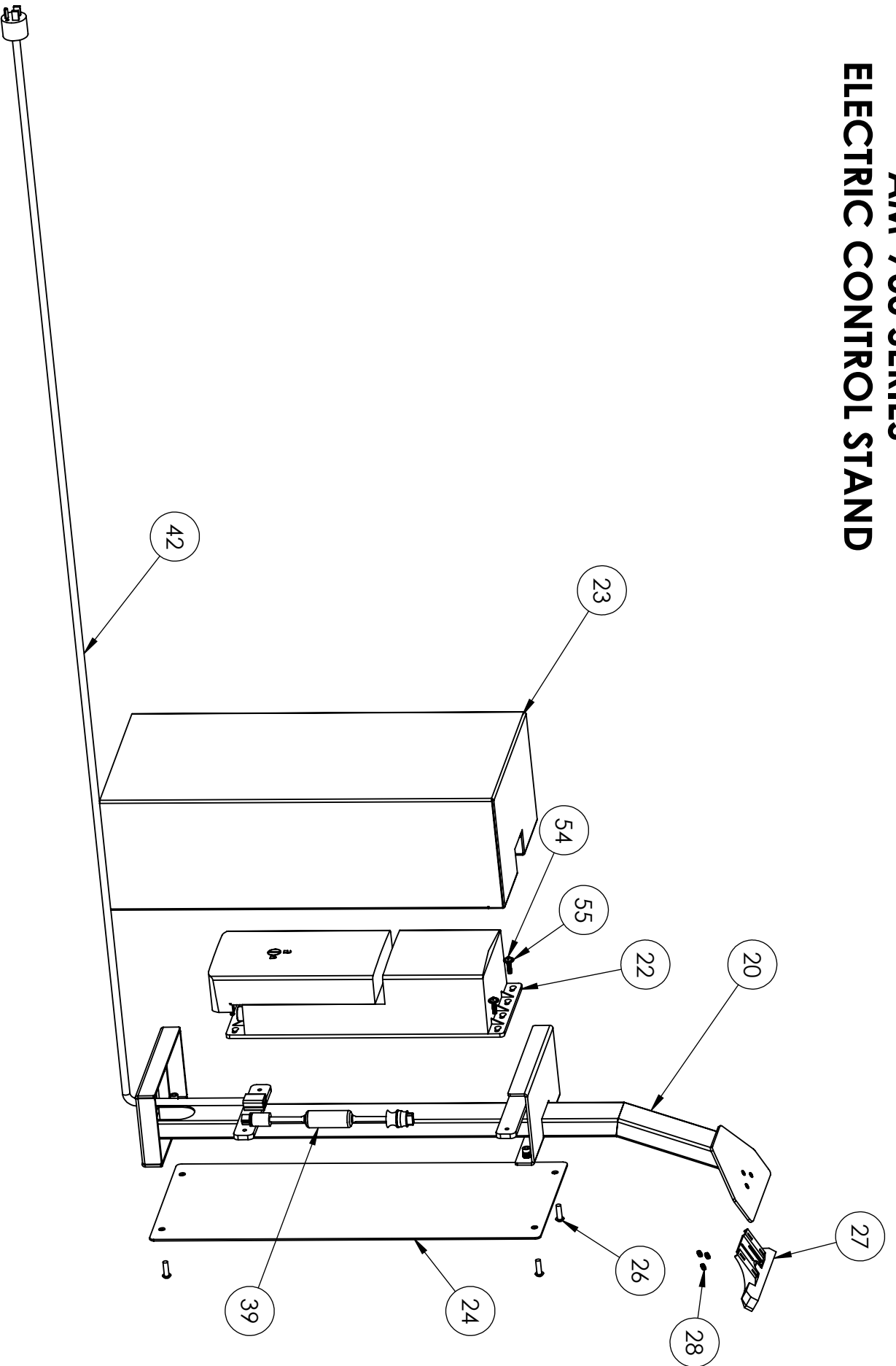

AM SERIES SPLIT PLATFORMS WITH END CONTROLS

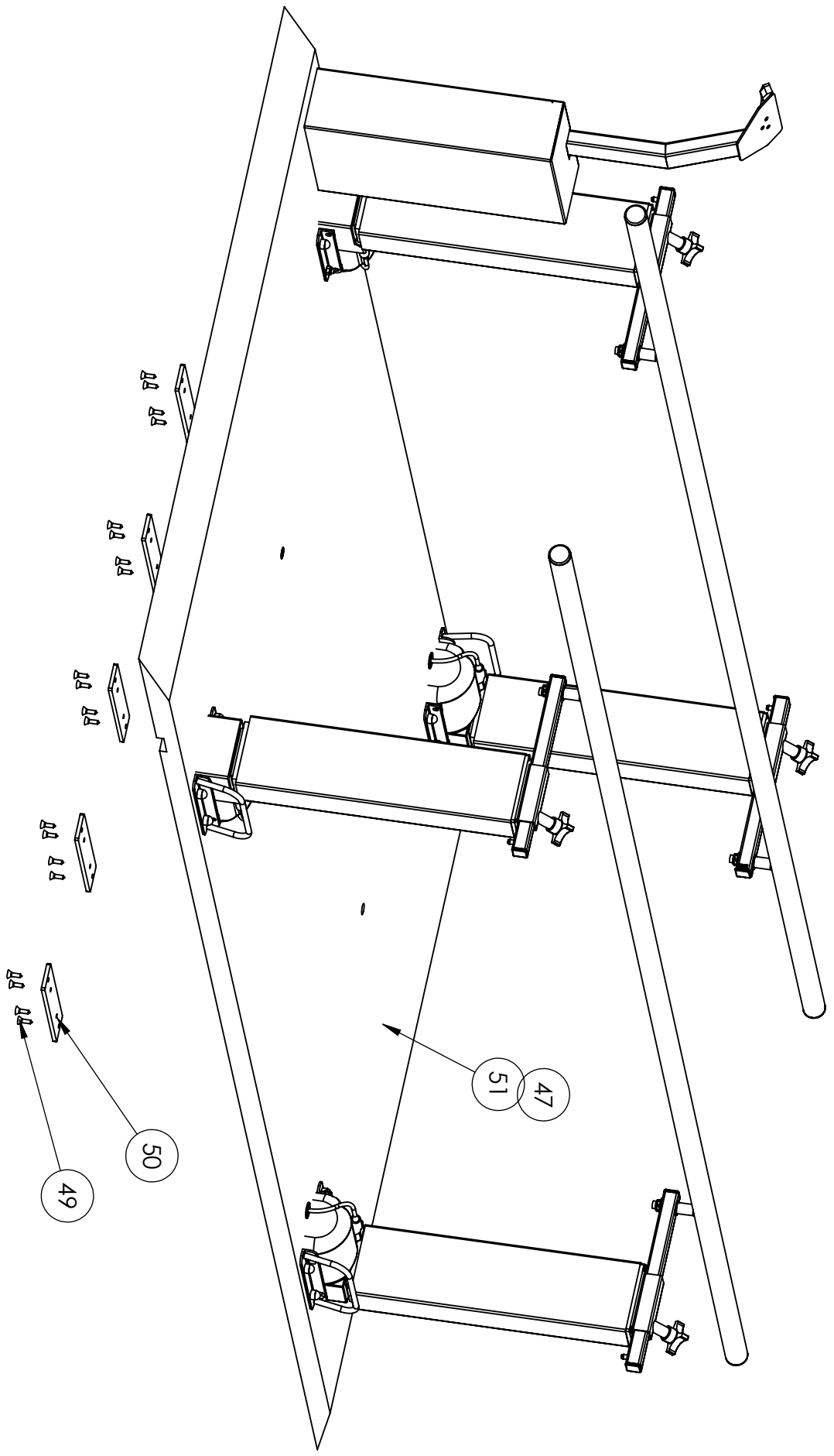

SPLIT PLATFORMS WITH END CONTROL

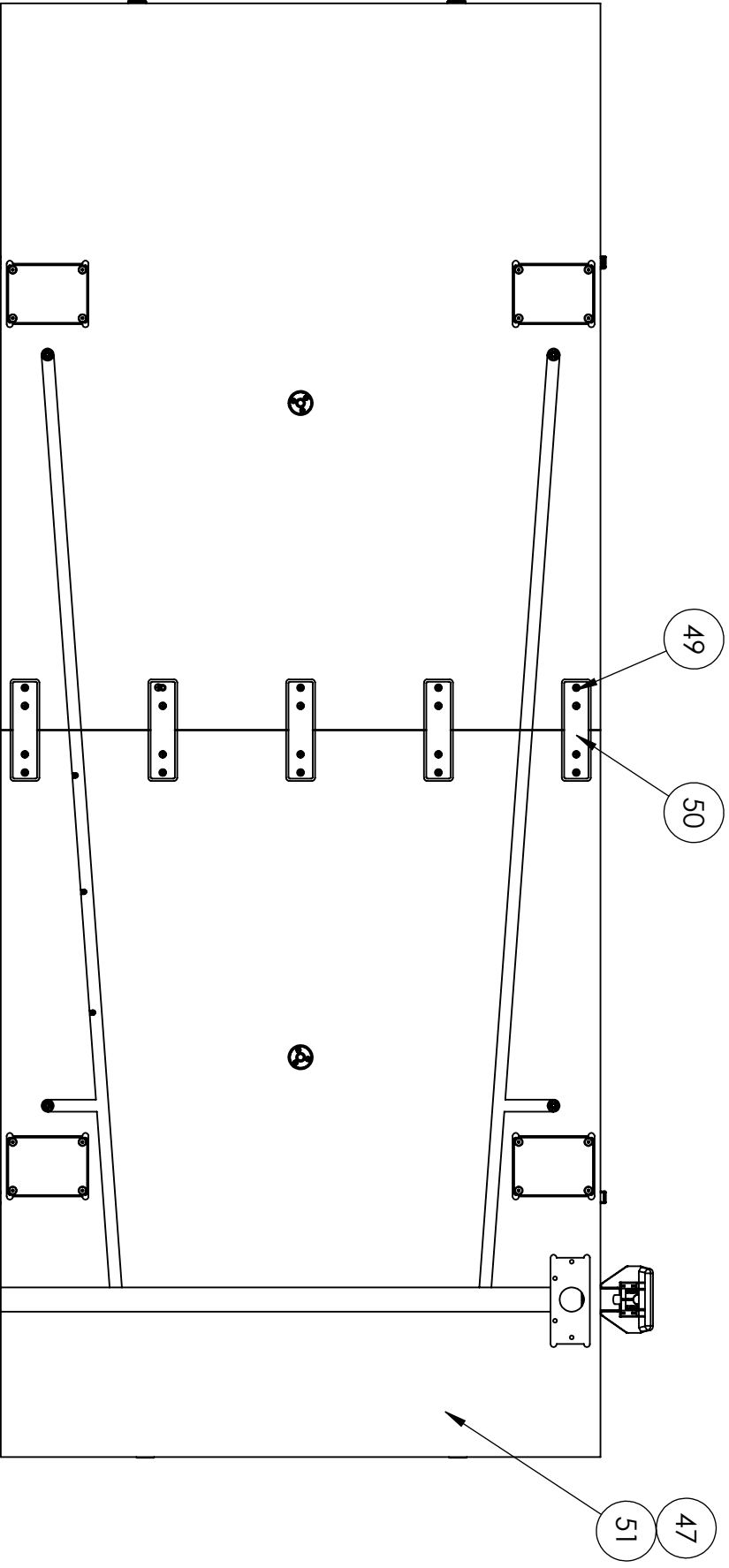
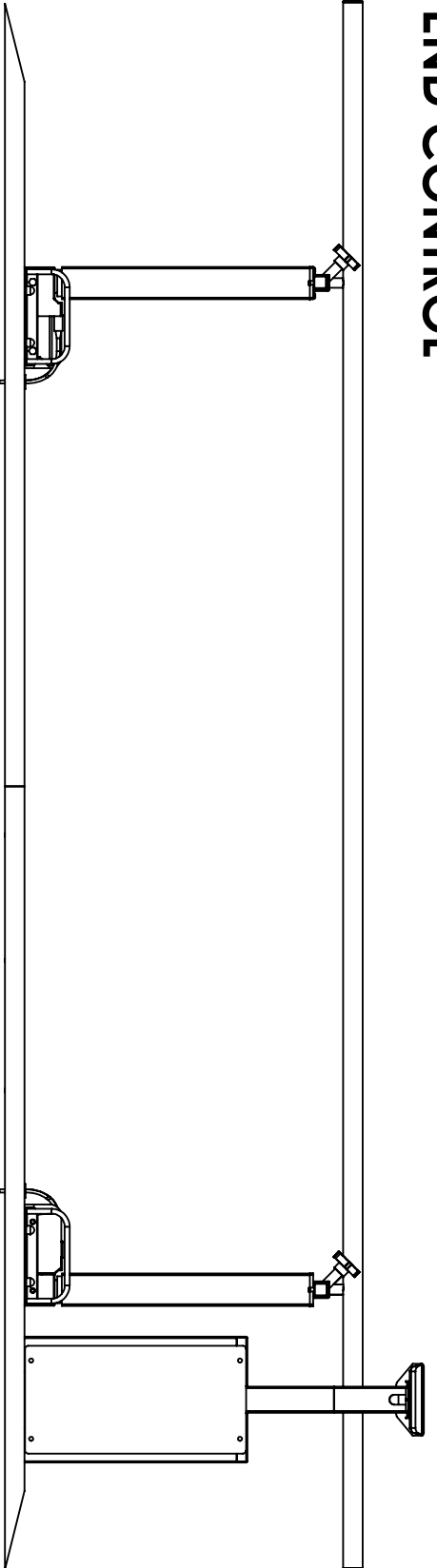

AM-715 BALANCE BEAM

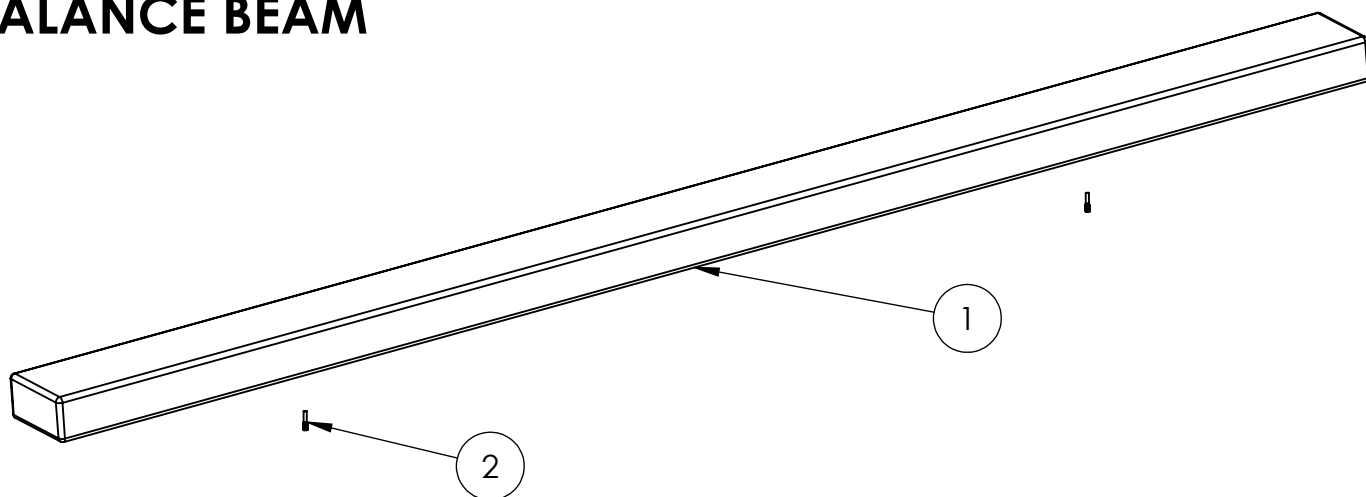

ITEM NO.	PART NUMBER	DESCRIPTION	QTY.
1	14604A	BD PLL BAL BEAM 2-1/2X5X80	1
2	13003A	SCREW 3/-16x3 MODIFIED 2-3/8 PIN	2

AM-714 ABDUCTION BOARD

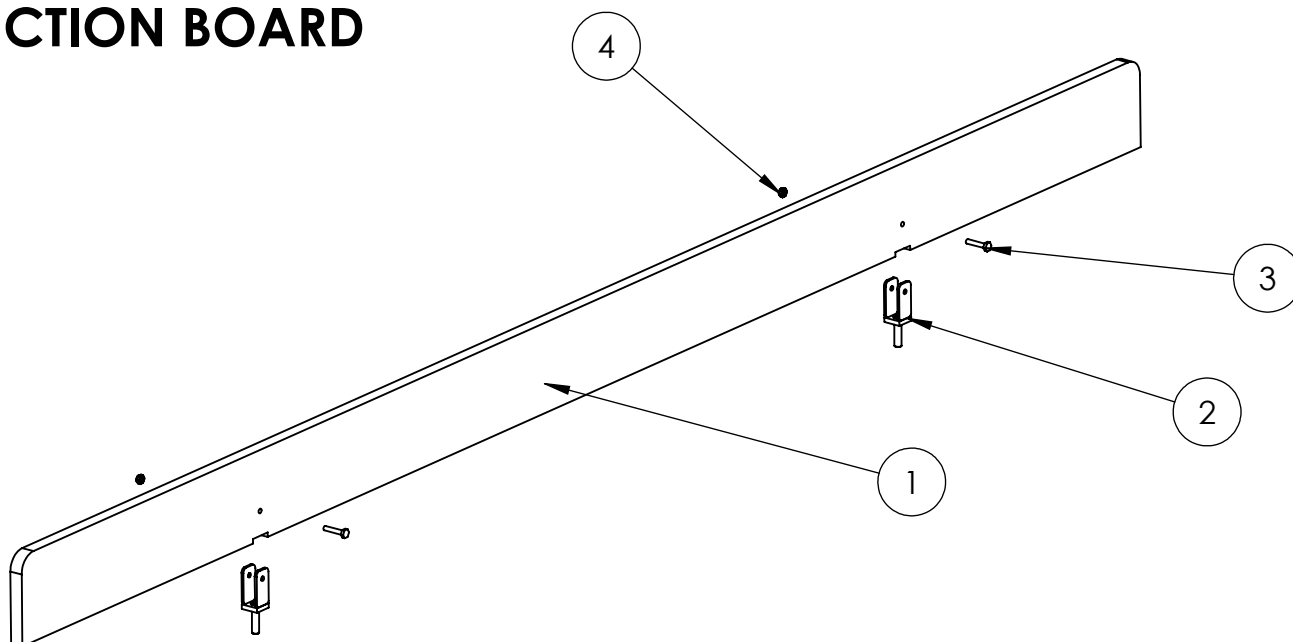

ITEM NO.	PART NUMBER	DESCRIPTION	QTY.
1	14603A	BD PLL ABDUCTION 3/4X5X94	1
2	18667	BRKT YOKE PLL BD PIN PLTD	2
3	02044	SCREW HX HD CAP 1/4-20x1-1/4	2
4	02084	NUT NYLOCK JAM 1/4-20	2

AM-716 FOOT PLACEMENT LADDER

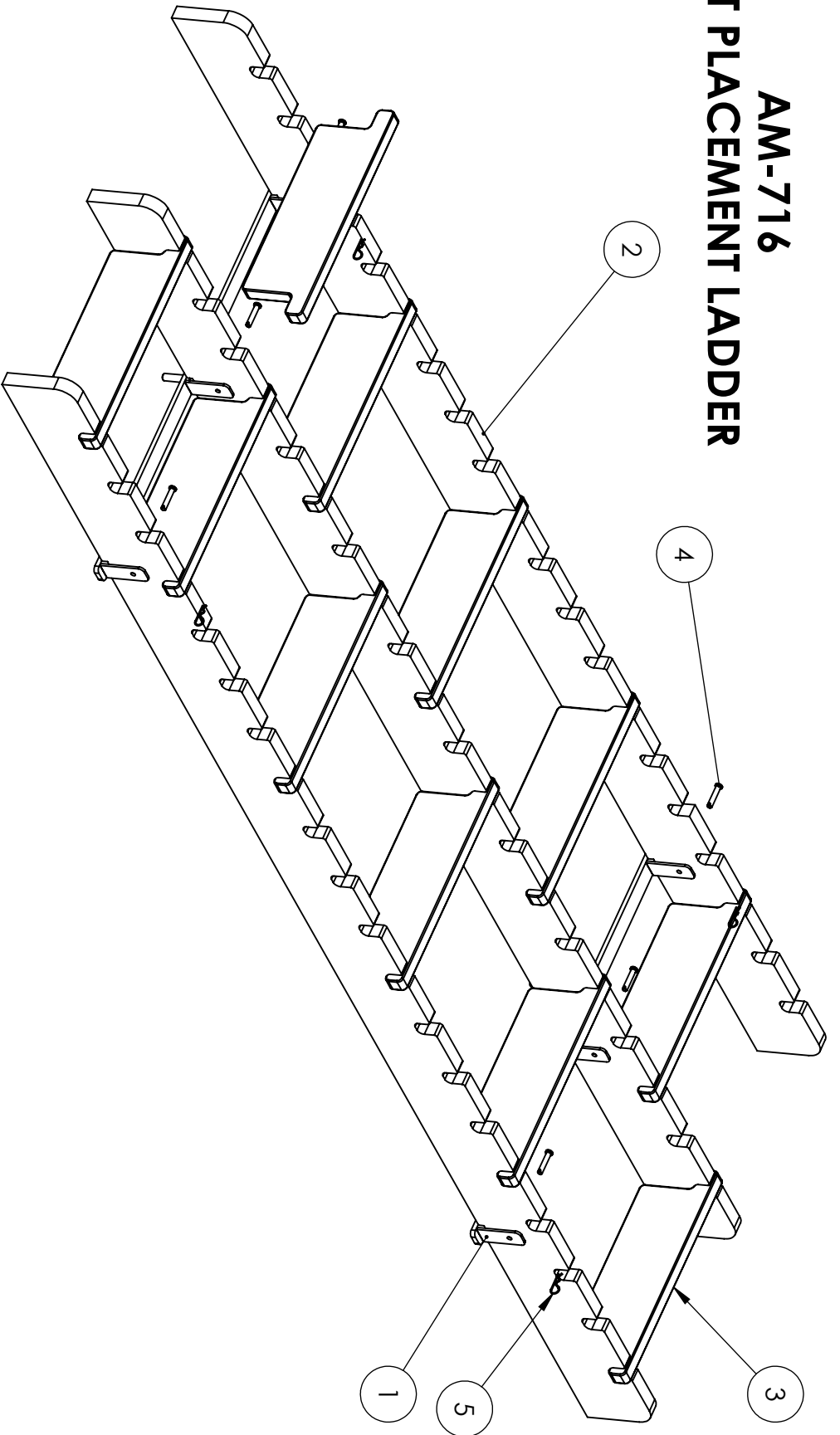

ITEM NO.	PART NUMBER	DESCRIPTION	QTY.
1	18658B	BAR 25-1/4 PLL LADDER GUIDE PNTD	2
2	14602A	BD 1X4X84 PLL PLCMNT LADDER NOTCHED	3
3	14606A	BD PLL LADDER CROSS 3/4X4X13-1/4	11
4	03163A	PIN CLEVIS 1/4X1-1/4	6
5	03173A	PIN HITCH CLIP 1/16X1-3/16	6

**ARMEDICA™ MANUFACTURING CORP.
LIMITED WARRANTY**

ARMEDICA™ Manufacturing Corp. warrants that the AM-700 Series Parallel Bars are free from defects in material and workmanship. This warranty shall remain in effect for 18 months from the date of original consumer purchase of the product. If the product fails to function during the warranty period due to a defect in material or workmanship, ARMEDICA™ Manufacturing Corp. or the selling Dealer will repair or replace the unit without charge within a 30 day period from the date on which the unit is returned to ARMEDICA™ Manufacturing Corp. or the selling Dealer. ARMEDICA™ Manufacturing Corp. has a policy of continuous improvement that may result in changes to specifications at any time.

THIS WARRANTY DOES NOT COVER

1. Replacement parts or labor furnished by anyone other than ARMEDICA™, selling dealer or approved ARMEDICA™ service agent.
2. Any failure of the unit during the warranty period if the failure is not caused by a defect in material or workmanship or if the failure is caused by unreasonable use, including the failure to provide reasonable and necessary maintenance.

**ARMEDICA™ MANUFACTURING CORP. IS NOT LIABLE FOR INCIDENTAL
OR CONSEQUENTIAL DAMAGE TO PROPERTY OR BUSINESS.**

To obtain service under this warranty, please do the following:

1. A written claim should be sent to ARMEDICA™ Manufacturing Corp., P.O. Box 880, Greenwood, AR. 72936-0880 or the selling Dealer.
2. The unit must be returned to ARMEDICA™ Manufacturing Corp. or the selling Dealer.
3. This warranty gives you specific legal rights and you may have other rights, which vary from state to state.
4. ARMEDICA™ Manufacturing Corp. reserves the right to change, modify or discontinue products and/or parts, at our discretion, without notification.

ARMEDICA™ does not authorize any person or dealer to create for it any other obligations or liabilities in connection with the sale of the units. Any representation or agreement not contained in this warranty shall be void.

CLASS I ELECTRICAL DEVICE		
IN RESPECT TO PROTECTION AGAINST ELECTRIC SHOCK		
Input: 120V  , 60 Htz, 8A (PEAK), Duty Cyc: Int. On/Off 1 min./9 min.		
ARMEDICA MFG. PARALLEL BARS		
Type B Applied Part Max. Load Static: 500 lb. (181 kg.)		
Model No.	Serial No.	Prod. Date
<input style="width: 100%;" type="text"/>	<input style="width: 100%;" type="text"/>	<input style="width: 100%;" type="text"/>
ARMEDICA MFG. 212 BELL RD., GREENWOOD, ARKANSAS, 72936 P/N 06057C		
CUSTOMER SERVICE (479) 996-2612		
Medical Electrical Equipment		
With respect to electric shock,		
Fire and Mechanical hazards only		
In accordance with 60601-1		
		

