

WiZARD 320 Full Face Mask Assembling Guide

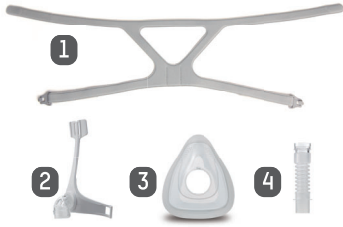

Component

- 1 WiZARD 310/320 Headgear with Buckles
- 2 WiZARD 320 Elbow Connector with frame
- 3 WiZARD 320 Full Face Mask Cushion, Large
- 3 WiZARD 320 Full Face Mask Cushion, Medium
- 3 WiZARD 320 Full Face Mask Cushion, Small
- 4 Silicon Tubing

Caution!

Please confirm that all the components belong to WiZARD 320 Full Face Mask by checking the reference number before assembling.

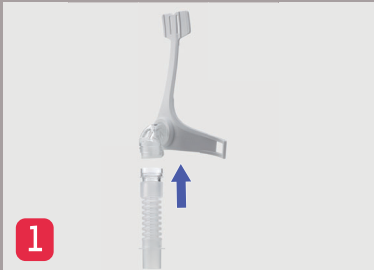

Connect the silicon tube to the frame directly



Align the arrow on cushion to the groove on frame and assemble them together directly



Lay flat the headgear with WiZARD label downwards



Place the frame on the center of headgear and hook on the buckles

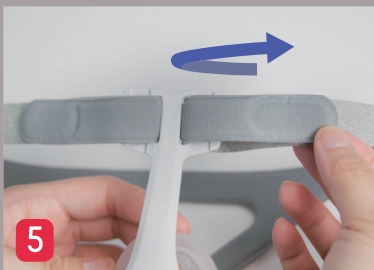

Assemble the upper straps through the holes in front of forehead pad and attach the velcros



Assembly completed. (The WiZARD logo should be outwards on the back of headgear)