

Sensory Wall Cascade

Safety

The Sensory Wall Cascade provides tactile and visual stimulation for all ages, however it is not a toy. The fixture's use MUST be supervised by an adult at all times. Users of the product must not attempt to hang from the fixture, climb on it or otherwise apply significant downward pressure as this could cause the unit to become detached from the mounting surface.

Always check the fixture for signs of wear or damage before each use. Safety is always our prime concern so please ensure you exercise your duty of care, observing Health & Safety guidelines, with adult supervision, and good common sense at all times.

Failure to follow proper installation procedures could lead to risk of the Cascade becoming detached from its mounting surface and could cause injury. Universal Fiber Optic Lighting are not responsible for injury caused by incorrect use of the product, or from inadequate installation practices being followed.

Before You Start Installation

Before undertaking installation, you will need to be aware of the type of wall you intend fixing the Cascade to. We offer a guide for installing into plasterboard / dry wall or alternatively into a solid brick or concrete wall. Please be aware that only you can judge a safe installation, so this guide should be adapted to the needs of your situation if required.

Installation into a plasterboard / dry wall

Two mounting methods ONLY are recommended for fitting the Sensory Cascade unit to a cavity wall as detailed below.

Method 1 - wooden plate on front face of cavity wall

Fix a plywood board (min. 18mm thick) to the front surface of the cavity wall and secure by fixing screws through the battens behind the cavity wall.

Secure the Cascade mounting plate onto the board.

Additional strength may be achieved by using a suitable adhesive between the board and the cavity wall.

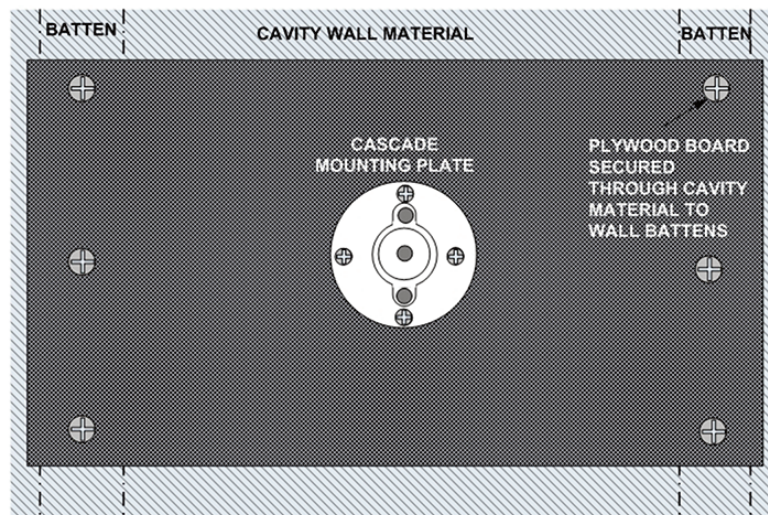

Method 2 - wooden plate behind cavity wall

Fix a plywood board (min. 18mm thick) to the rear surface of the cavity wall so that it fits tightly between the battens. secure the board by fixing screws through into the battens.

Secure the Cascade mounting plate onto the surface of the wall so that the fixing screws are tight into the wooden board.

Additional strength may be achieved by using a suitable adhesive between the board and the cavity wall.

Note

Screw lengths for these two methods will depend on the thickness of the cavity wall material and the thickness of the plywood board.

Please be aware that cavity fixings on their own are insufficient to hold the Cascade assembly under load conditions.

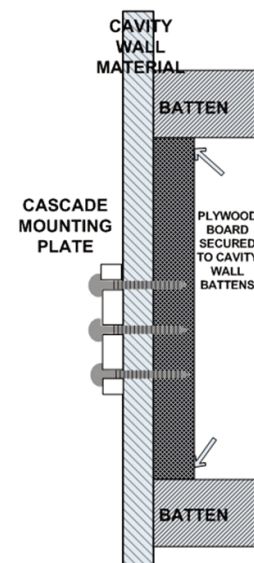

Sensory Wall Cascade

Installation into a solid surface - concrete, solid brick, hollow brick, perforated brick or aerated concrete

Installation into this surface type uses a universal plastic expansion plug fitting, i.e. a Rawlplug or similar.

This method is suitable for most solid surfaces and will require use of a suitable drill. The size of drill bit is dependant on the plug size chosen.

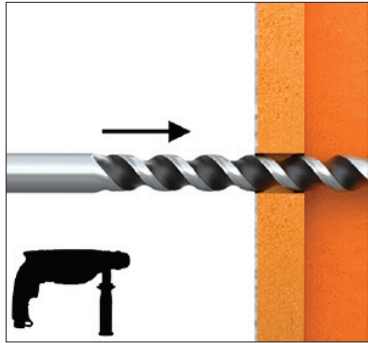

Drill hole of required diameter.

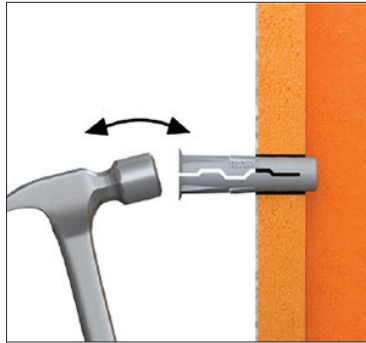

Insert plug into hole and tap home.

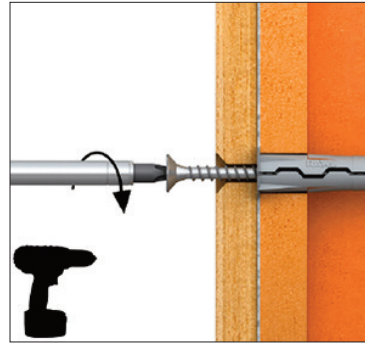

Insert screw of required diameter into plug, through Cascade mounting plate & tighten.

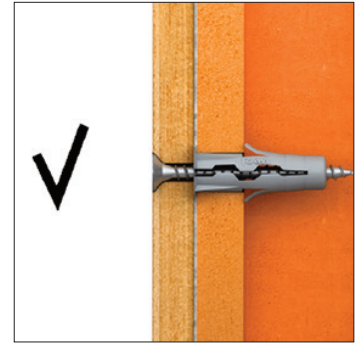

Note

Select screws and expansion plugs that once fitted will provide a minimum load force per screw of 0.15kN (15kg pulling force per screw). Always fit 4 screws to effectively and safely secure the mounting plate.

Cascade Fixing Guide

An overview of the complete fixing process is shown below.

