

**6000 SERIES
6BED30
Hospital Bed**
(FSS#V797D-30167 ITEM#600030)

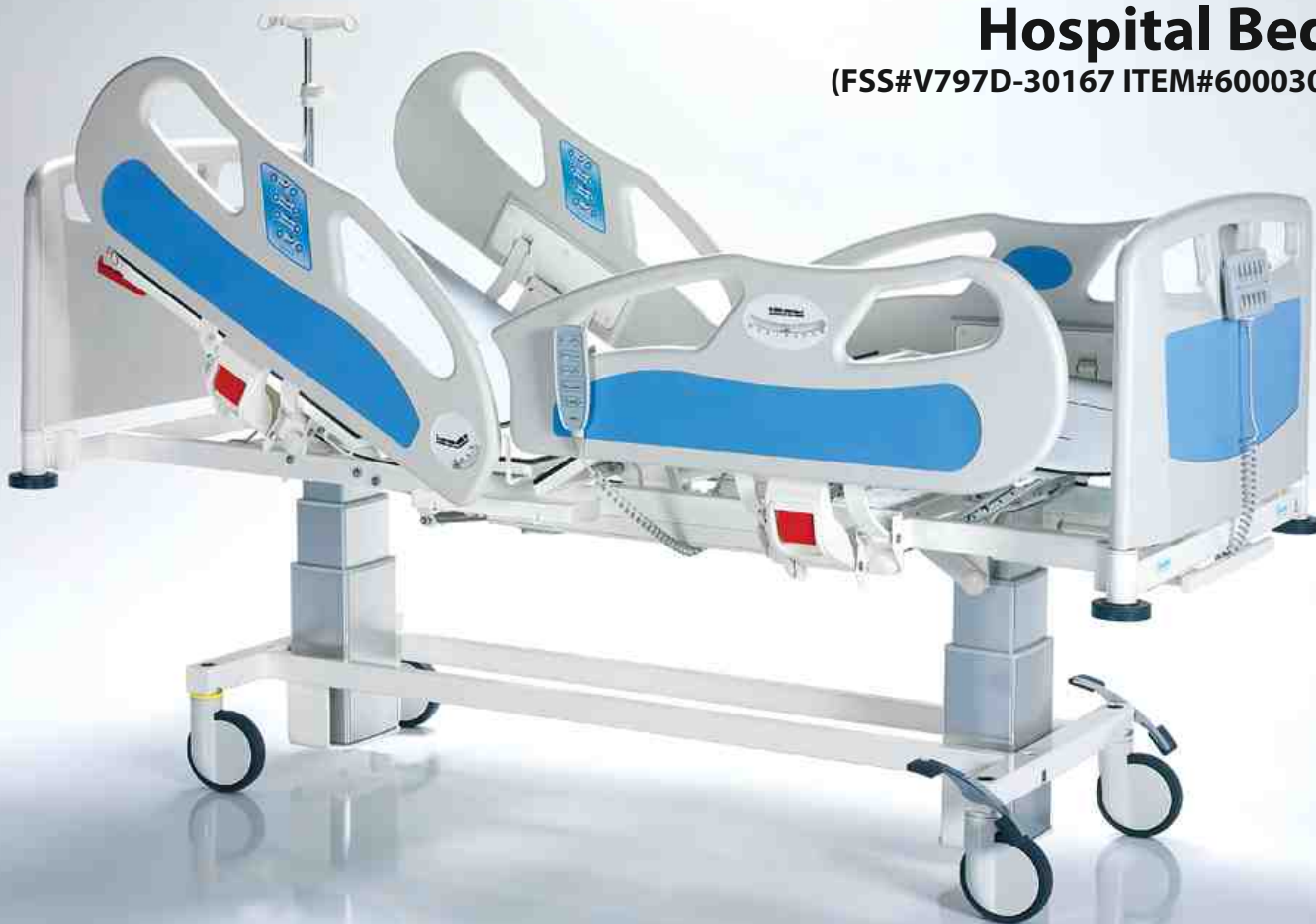

Extendable Foot Section

Central Locking Brake
Removable Headboard

Handset for Patient

Side Control Panel

Nurse Control Panel

Emergency CPR

Purpose

The 2, 3 and 4 motor hospital bed offers complete functionality and comfort for both patient and caregiver. With many additional features such as central locking brakes, single-lift trendelenburg, Emergency Relief CPR handle, urine and O2 holders, side mounted and nurse lock controller functionality, the 6BED30 can be customized and outfitted to your needs. Mattress not included.

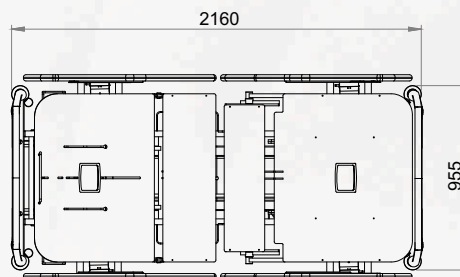
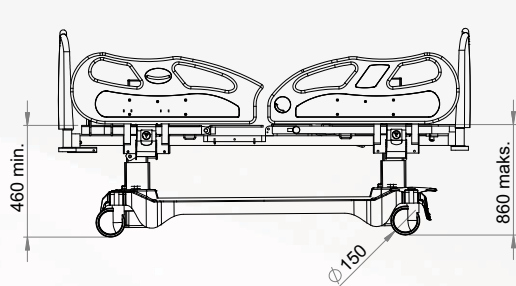

TECHNICAL FEATURES

MOVEMENTS 5 MOTORS	BACKREST, LEGREST, HEIGHT, TRENDELENBURG, REVERSE TRENDELENBURG MOVEMENTS
CONTROL PANELS	PATIENT REMOTE CONTROLLER AND OPTIONAL NURSE CONTROL PANEL WHICH CAN LOCK PATIENT REMOTE CONTROLLER USAGE
TRENDELENBURG / REVERSE TRENDELENBURG	TRENDELENBURG / REVERSE TRENDELENBURG BY MOTORS MIN : 0-18 DEGREE
HEADINGS AND SIDE RAILS STRUCTURE	PRODUCED FROM POLYPOPILEN ABS MATERIAL
METAL STRUCTURE	THICKNESS FOR BOX PROFILE : 1,2 - 2,00 mm. FOR PIPE 1,2 - 2,00 mm
PAINTING	ELECTROSTATIC POWDER COATING
ELECTRONIC CPR	WITH NURSE CONTROL PANEL
MANUAL CPR	YES, WITH HANDLES ON BOTH SIDES OF BACK REST
X-RAY CASSETTE HOLDER	STANDART
CASTORS	DIAMETER 150 mm / TENTE OR RHOMBUS
5.CASTORS	STANDART
LOCKING OF CASTORS	CENTRAL LOCKING SYSTEM, 1.STEP (UP) :DIRECTIONAL CASTOR (YELLOW COLOUR) , 2.STEP (MIDDLE) : FREE CASTORS (FOR ALL CASTORS), 3.STEP (DOWN) : BRAKE OPEN FOR 4 CASTORS
AUTO REGRESSION	YES.100 mm
PROTECTION BUMPERS	4 PCS BUMPERS ON CORNERS, DIAMETER : 90 mm
BATTERY	STANDART
IV POLE	YES, METAL, 1,2 mm, CHROMED, 2 HOOKS
DRAINAGE HOOKS	YES
MANUAL KNEE MECHANISM	YES, MANUAL KNEE MECHANISM WITH 3 GRADUAL POSITION
BOTTOM FRAME SIZE	50 x 50 x 3 mm / 30 x 50 x 2 mm
UPPER FRAME SIZE	50 x 30 x 2 mm / 20 x 20 x 2 mm
SIZES	W : 955 mm, L : 2160 mm
HEIGHT	MIN : 460 mm, MAX : 860 mm
MATTRESS	860 x 1950 x 120 mm 32 DENSITY, WATER RESISTANT, FIRE RETARDANT MATTRESS

Standart Specification

* MOTORIZED HEADREST ADJUSTMENT * MOTORIZED LEGREST ADJUSTMENT * MOTORIZED HEIGHT ADJUSTMENT * MOTORIZED TRENDELENBURG / REVERSE TRENDELENBURG ADJUSTMENT * HAND CONTROL UNIT * ELECTRONIC CPR.MECHANICAL CPR (FLAT POSITION OF BED BACKREST FOR EMERGENCY) * FOWLER AND VASCULAR POSITIONS.* KNEE MOVES ADJUSTMENT WITH GRADUAL MECHANISM.* EASILY REMOVABLE FIXED HEAD / FOOT BOARDS * SIDE RAILS MADE FROM POLYPROPYLENE MATERIAL * 360° MOVABLE CASTORS WITH CENTRAL LOCKING (150 mm).* PLASTIC PROTECTION BUMPERS.* BELT HOOK * ACCESSORIES SLOTS.* URINE BAG HOLDER.* HEIGHT ADJUSTABLE IV POLE * ELECTROSTATIC POWDER COATING.* BATTERY * X-RAY AT BACKREST * BED EXTENCION (18 cm) * 360° MOVABLE CASTORS WITH CENTRAL LOCKING (150 mm) * NURSE CONTROL PANEL* 5th CASTOR • MATTRESS NOT INCLUDED

Extra Cost Options

32 DENSITY MATTRESS	WEIGHT SCALE SYSTEM
VISCO MATTRESS	LATERAL SYSTEM
DOUBLE CASTORS Q 150	CONTROL PANEL ON SIDE RAIL
	HAND GRIPS