

DUAL SPORT CONNECTOR HOSE

Usage Tips: There are a few things that you can do to maximize the performance of your Dual Connector Hose:

- Try and minimize any difference in elevation between the two Wraps being used.
- Make sure that both Wraps are applied snugly to the body.
- Verify that the Dual Connector Hose is attached securely to both Wraps and is not kinked.
- Do not remove either Wrap during treatment. Always pause the Control Unit before removing a Wrap.
- Never use the Dual Connector Hose with a single Wrap; the Dual Connector Hose will only provide treatment to two Wraps simultaneously.

Note: When different body parts are treated simultaneously on the same patient, the patient may feel that one Wrap is providing more cold or compression than another even if both Wraps are functioning properly. This is a result of differing sensitivities of different body parts to both cold and compression.

Care & Storage: The Dual Connector Hose can be cleaned using soap or mild detergent and water. Using any other cleaning or sterilizing agent may damage or destroy the hose and void all warranties.

The Dual Connector Hose should be stored coiled. It must not be left kinked or compressed.

Warranty Information: Your Game Ready Dual Connector Hose carries a one-year warranty from the date of purchase.

CoolSystems, Inc.

1201 Marina Village Pkwy Suite 200

Alameda, CA 94501

1.888.GAMEREDDY

EC REP

EMERGO EUROPE
Molenstraat 15
2513 BH, The Hague
The Netherlands



Dual Connector Hose

Getting Started:

- Connect the single end (the side with the red connector button) of the Dual Connector Hose to your Game Ready Control Unit.
- Apply both Wraps to the patient(s) being treated. Make sure the Wraps are applied snugly and correctly.
- Connect the ends of the Dual Hose to the Wraps you are using for treatment*.
- Verify that the Dual Connector Hose is securely connected to both Wraps and to the Control Unit.
- Press the Control Unit's Start Button. Note that the Control Unit will provide the same level of cold and compression to both Wraps.

NOTE: It is not possible to control cold and compression in each Wrap individually.

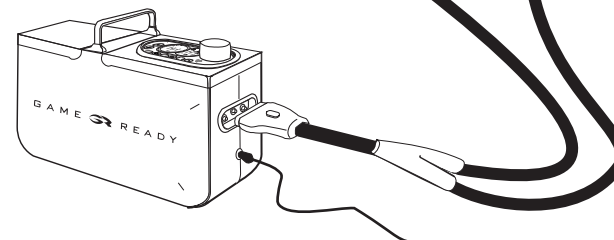
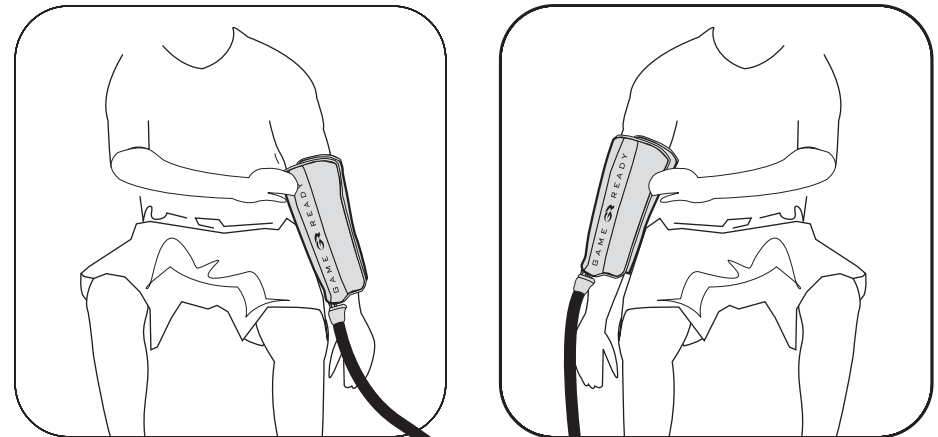

* The Dual Connector Hose must be attached to two Wraps. It cannot be used with only a single Wrap.