

HYDRAULIC PATIENT LIFT

MOB1068

vive



OWNER'S MANUAL

HYDRAULIC PATIENT LIFT

PARTS DESCRIPTION

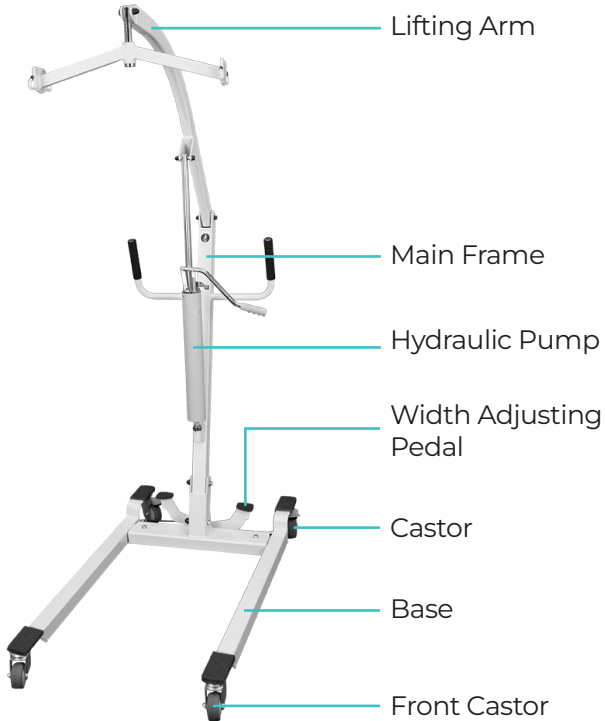

HARDWARE INCLUDED

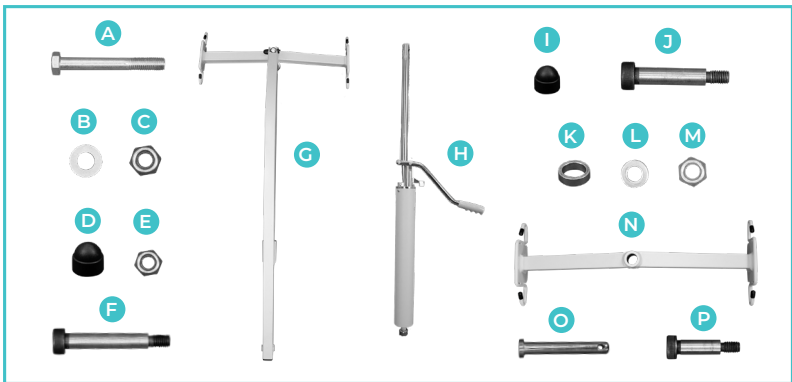

- Hexagon bolt M10x75 x2 (A)
- Washer x2 (B)
- Lock Nut x2 (C)
- Nut Cap x2 (D)
- Small Nut x3 (E)
- Hexagon bolt M10x70 (F)
- Lifting Arm (G)
- Hydraulic Pump (H)
- Small Nut Cap x3 (I)
- Hexagon bolt M10x60 (J)
- Spacer x2 (K)
- Small Washer x3 (L)
- Small Lock Nut x3 (M)
- Sling Holder (N)
- Sling Holder Support Pipe (O)
- Hexagon bolt M10x55 (P)

NOTE:

Some hardware is pre-installed onto the device. Sling not included.

ASSEMBLY INSTRUCTIONS

1. Place the Main Frame Arm and align the holes with the Base. Fix (A) M10x75 hexagon bolt with (B) Washer and insert it through both the holes on the base. Attach the (C) nut and to the other end and tighten down using your wrenches. Then place the nut cap (D) on the nut.

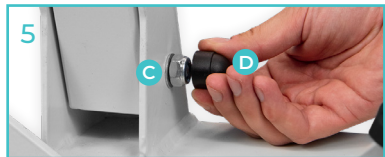
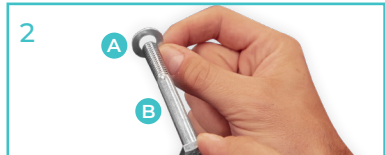

2. Insert the Lifting Arm (G) into the upper groove of the frame. Make sure the holes are in alignment and then slip the Hexagon bolt M10x70 (F) with a Small Washer (L) through the hole. On the opposite side attach another Small Washer (L) and a Small Lock Nut (M). Tighten down with a wrench and an allen key, finally and attach the Small Nut Cap (I). There should be no movement of the lifting arm.

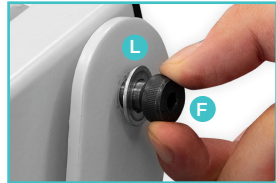

3. Install the Hydraulic Pump by first putting the ball-end of the hydraulic cylinder into main frame. Secure it with the fixed Lock Nut (C) to lock the bolt in place.



4. Finish the Installation of the Hydraulic Pump (H) by attaching the top part to the Lifting Arm (G) by first lining up the holes. Insert a Small Washer (L) onto the Hexagon bolt M10x60 (J) then slide through the first hole. On the other side of the first hole be ready with a Spacer (K). Continue on through the hole of the top of the Hydraulic Pump. Then on the other side of that add another spacer, then continue on through the last hole. On the opposite side attach another Small Washer (L) and a Small Lock Nut (M). Tighten down with a wrench and an allen key. Finally and attach the Small Nut Cap (I). When finished you should have a space on each side of the hydraulic pump pipe.

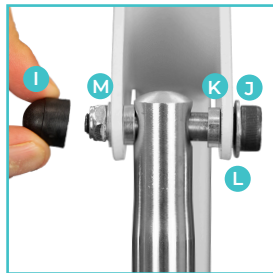
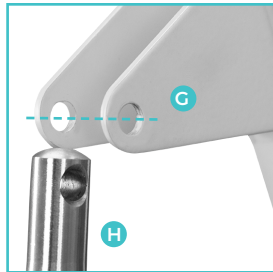

5. Insert (O) Sling Holder Pipe into the (N) Sling Holder. Attach this new piece to the Lifting Arm by aligning the holes on the Lifting Arm and the Sling Holder Pipe. Use the (P) Hexagon bolt M10x55 to secure the two together along with the Small Washer (L) and a Small Lock Nut (M). Tighten down with a wrench and an allen key, finally and attach the Small Nut Cap (I).

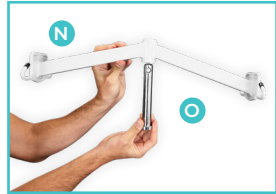

HYDRAULICS HANDLING PROCEDURE

Slide the valve switch Inwards (towards the lift handle) to Lock the downward ability of the lift.



Operate the hydraulic handle up and down to lift the patient.



Slide the valve switch outwards (Away from the lift handle) and the hydraulic cylinder will decline, relying on the patient's own weight. When it declines to a requested height, re-lock the valve switch.



NOTE:

The amount you push the switch outward will affect the speed of how fast the patient is lowered. Use caution to gauge how much to move the switch outward vs. how fast you want to lower the patient. Never flip the switch all the way outward without slowly testing your speeds as every patient's speed is different due to their weights.

Base Width Adjustment:

The width of the base can be adjusted by pedal. Press on the left pedal for a wider base and the pedal on the right for a more narrow base.

**Lock and Unlock Rear Wheels:**

The rear wheels can be locked. Use your foot to lock and unlock the rear wheels.

**ATTENTION:**

It is unnecessary to lock the rear wheels for most ascent and descent movements. Only lock the wheels when the lift moves and may cause personal injury.

WARNING:

Locking the rear wheels of the lift may increase the risk of tipping during the ascent and descent of a patient.

OPERATION OF PATIENT LIFT

Keep the lifting arm and patient's body vertical. Make sure the operation of the lift is correct each time.

WARNING:

An imbalance during ascent increases the risk of tipping. Always use on flat grounds.

Check and ensure the following items after finishing the assembling process:

- All connections are properly locked and there are no loose parts.
- The hydraulic cylinder rises properly after turning on the valve switch and while operating the handle up and down.
- The hydraulic cylinder descends properly with weight loaded after turning off the valve switch.
- The 4 casters function properly.

CARE AND MAINTENANCE

- Washing with a household cleaning agent.
- Use a dried cloth with a diluted neutral detergent to wipe any stains or grease.
- Lacquer thinner, gasoline, Kerosene, volatile solvents, wax, sponges, and abrasive brushes are not permitted.

TROUBLESHOOTING

Patient Lift Doesn't Work

Check if there is any damage to the hydraulic cylinder.

MAINTENANCE RECORD

Date	Fault	Cause	Remark

SPECIFICATIONS

Device Name	Hydraulic Patient Lift
Model/type	MOB1068
Product Size	47.25"×24.5" ×48.25"
Fork Range	24.5" - 31.5" adjustable
Lifting Range	31" (lowest), 68" (highest)
Maximum Capacity	400 lbs.
Net Weight	86 lbs.

WARNINGS

- Lift should only be operated by adults with proper knowledge of how to handle a lift and properly position a lift sling. Consult with a care giver before attempting to use this device with no prior knowledge of how it works.
- Maximum User Weight: 400lbs

NOTE:

Make sure the sling you purchase can hold equal to or more weight.

- Always gauge the speed of the hydraulic pumps lowering ability per patient. Never release the valve all the way and drop the patient at full speed without first slowly testing the speed.

