

*Experience for yourself!*

The Spartan VED was specially designed to consider ease of use, quality, comfort, appearance, and **POWER.**

### **What is a Vacuum Erection Device (Penis Pump)?**

Vacuum Erection Systems (VED) are designed to help millions of men suffering from Erectile Dysfunction (ED) with greater than 90% satisfaction in various studies.

More than 40 million American men suffer from ED of various causes. Medical grade VED systems are an excellent drug-free and non-invasive option to obtain satisfactory erection.

Vacuum Erection Device is a medical pump which creates a vacuum in the cylinder around the penis. This draws blood in the shaft of the penis and causes it to swell and become erect. One of the constriction rings is then slid down over the shaft of the penis. This prevents the blood from flowing back out of the penis when the cylinder is removed and helps maintain erection. Please look inside this brochure for step by step details for proper application of these effective treatments.



Home of the Best Urology Products for Men and Women

## **VACUUM ERECTION SYSTEMS (VED)**

For Management of Erectile Dysfunction (ED)



*Ready to upgrade to Spartan today?*

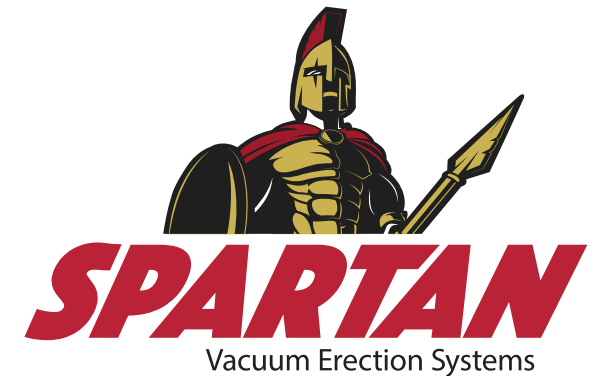



Spartan® VED Systems offer a free\* 3-year warranty on Spartan VEDs.

See website for details

MADE IN THE U.S.A.



### Spartan® Automatic (Battery) System

Price: \$349.95

*Creates suction with a simple one touch button operation!*

Includes: 1 Cylinder Tube (with easy air-release valve), 1 Pump Head (battery operated), 2 Adaptor Bushings pre-inserted in the Cylinder tube, 1 Loading Cone, 3 Constriction Rings – (sizes A, B, & C), 1 Tube of Water-Based Lubricant, 1 Storage Bag, 1 User Manual, 3 AA Batteries.

- Better option for men with arthritis or issues with strength in their hands.
- High quality, medical grade materials
- Creates suction with a simple one touch button operation!

### Spartan® Constriction Rings

Price: \$19.95 (per ring)



Constrictions Rings are the most important item of a vacuum erection device (VED). Often called tension and support rings; Spartan® Constrictions Rings are specially designed for durability, comfort, and efficacy. Once a VED is used to achieve the desired erection, the ring is easily applied to the base of the penis to help maintain the erection.

- Once the correct size is determined, a ring should last 3-4 months.
- Ensure to use water-based lubricant only!
- Do not wear a constriction ring for more than 30 minutes at a time.

Sizes available in: A = 8 mm B = 10 mm C = 11.5 mm



### Spartan® Manual System

Price: \$249.95

Includes: 1 Cylinder Tube (with easy air-release valve), 1 Pump Head (manual operated), 2 Adaptor Bushings pre-inserted in the Cylinder tube, 1 Loading Cone, 3 Constriction Rings – (sizes A, B, & C), 1 Tube of Water-Based Lubricant, 1 Storage Bag, 1 User Manual.

- Easy to use
- Modestly priced
- High quality, medical grade materials
- The most powerful manual system available

### MAINTAIN® Constriction Loop Ring

For Erectile Dysfunction (ED) and Premature Ejaculation (PE)

Price: \$26.95



Designed to improve erection rigidity by enhancing venous compression. To be placed around the base of the penis and tightened, this pressure assists with achieving and maintaining erection rigidity. The Maintain™ Loop can be tightened or loosened to customize the fit and comfort for each individual.

Premium adjustable penile constriction “Actis” loop.

# STEP-BY-STEP VED INSTRUCTIONS



**Step 1:** Remove both pre-inserted grey rubber adapter bushing from Cylinder.



**Step 2:** Place the loading cone on the cylinder (where you just removed the bushings from). It will sit loosely.



**Step 3:** Choose the “B” size ring. Slide the “middle hole” of the constrictions ring over the loading cone onto the cylinder. Using a small “pea” size amount of water-based lubricant will help slide the constrictions ring over the tip of the cone and down onto the cylinder. This will take a bit of force. Hint: Placing the cylinder in between your thighs on a chair will help you apply the ring onto the cylinder better.



**Step 4:** Once the Ring is slid onto the cylinder, you can now remove the loading cone. You are done using the loading cone.



**Step 5:** Re-Insert your Grey Rubber Bushings. These adaptor bushings are provided to fit different size users.



**Step 6:** Locate the RED air release valve. Simply push the valve in towards the cylinder tube. This will statically connect the valve to the cylinder and not allow air to release prematurely. HINT: Pushing the RED air release valve up or pushing the RED air release valve down will allow air to release. You will do this later in the steps to remove the cylinder from your body and release pressure.



**Step 7:** Attach the pump head on to the Cylinder tube, closest to the end with the RED air release valve.



**Step 8:** Apply the water-based lubricant to the base of the penis and to the inside of the cylinder tube/adaptor bushings. This will help with forming a good vacuum seal and prevent the penis from sticking to the sides of the cylinder. Trimming pubic hair is recommended.



**Step 9:** Insert the penis into the cylinder tube and apply slight pressure towards the body. Standing up will help produce the best results.

**Step 10:** Start to pump.

If using the **manual** pump head – hold the cylinder with one hand and press down on the pump head with the other hand (towards the body) to create vacuum in the cylinder. Two to four pumps will create a low-level vacuum seal against your body. Take a break for 2 - 4 seconds, while keeping the pump on your body. This allows your body to naturally pull in the blood flow itself. Repeat this step 8-10 times until you have obtained an erection. (This may take 1 - 2 minutes)

If using the **battery** pump head – hold the cylinder with one hand and press the power button on the pump head with the other hand for 2-4 seconds to create a low-level vacuum seal against your body. Take a break for 2-4 seconds, while keeping the pump on your body to allow your body to naturally pull in the blood flow itself. Repeat this step 8-10 times, until you have obtained an erection. (This may take 1 - 2 minutes)



**Step 11:** As soon as the desired erection is created, slide the constrictions ring off of the cylinder tube and onto the base of the penis. (Do not wear the constrictions ring for more than 30 minutes)

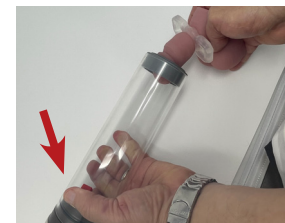

**Step 12:** Any vacuum pressure remaining can be easily depressed by pressing the air release valve down (towards the body) to release air pressure.

