

Smart Plug User Manual

SAT-0155

1.PRODUCT OVERVIEW

The Smart Plug is a WiFi based device which can be used to control electrical appliances after pairing to the WiFi network. You also monitor the on/off status of the desired appliance(s) through your mobile phone from anywhere as long as you have Internet access.

2.PACKAGE CONTENTS

- 1x Smart Plug
- 1x User Manual

3.PRODUCT FEATURES

- Support WiFi connection
- Firmware upgrades via OTA (over the air) updates
- Easy plug and play installation
- Timing task settings supported
- Over current protection

4.PRODUCT STRUCTURE

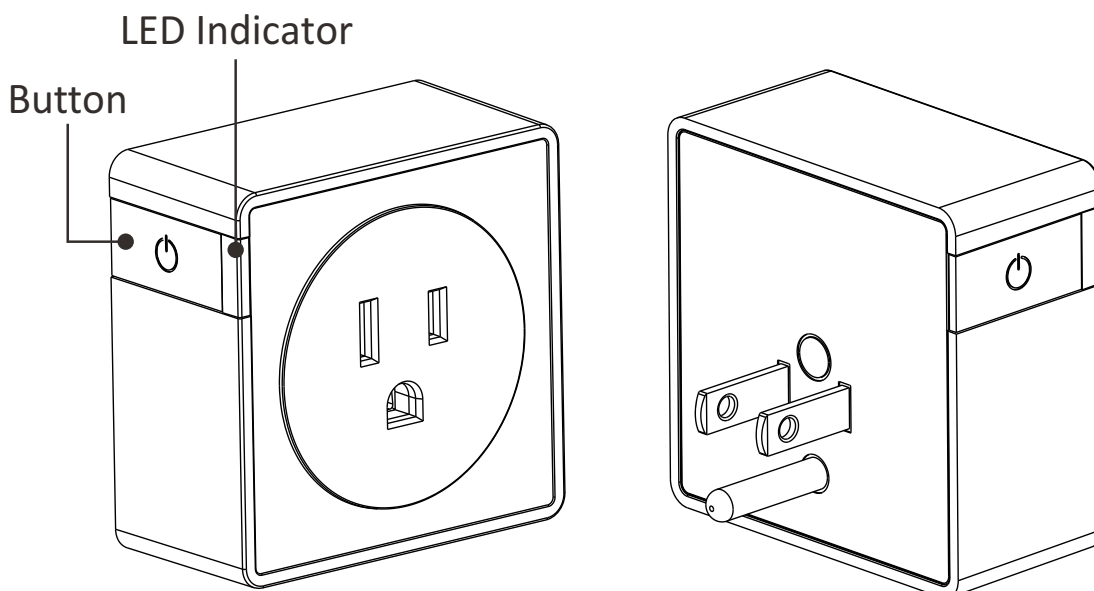

5.SPECIFICATIONS

| | |
|--------------------------|--|
| Power supply: | AC 90-135V,60Hz |
| Power loss: | ≤1W |
| Nominal input voltage: | 120V |
| Rated current: | 15A max |
| Storage temperature: | -20~+60°C |
| Operational temperature: | -10~40°C |
| Relative humidity: | 8%~80% |
| Wireless standard: | IEEE802.11 b/g/n |
| Radio frequency: | 2.4GHz—2.4835GHz |
| Encryption type: | WEP/TKIP/AES,WPS |
| Transmit power: | 802.11b:17dBm±2dBm@1Mbps 802.11g:15dBm±2dBm@54Mbps 802.11n:13dBm±2dBm@MCS7_HT20 |
| Sensitivity: | 802.11b:-91dBm@11Mbps 8%PER 802.11g:-75dBm@54Mbps 10%PER 802.11n:-72dBm@MCS7_HT20 10%PER |
| Vector error EVM : | 802.11b:≤35% 802.11g:-28dBm max. 802.11n:-28dBm max.@MCS7_HT20 |

6.POWER INDICATOR

| SAT-0155 | SAT-0155 |
|-----------------------------|--|
| OFF: Purple red ON: Blue | OFF: Purple red 0~300W: Blue 300~600W: Cyan 600~900W: Green 900~1200W: Yellow 1200~1500W: Red 1500~1800W: Purple |

When the Power of the load changes from low to high, the color of indicator will change in cycle as “blue, cyan, green, yellow, red, purple...”. Total 6 grades, 300W each as difference. When the power is over 1800W (6th grade). The indicator will blink in purple and shut off the output in 10 seconds. (Applicable only to SAT-0155)

7.ADD & DELETE DEVICES

Scan the following QR codes to download APP for Android and iOS Devices



Android



iOS

7.1. Add Devices

- Auto mode

The moment the plug is powered, the LED Indicator will be solid blue. Choose Auto Scan to begin the automatic pairing process. The LED indicator will blink green. The app will indicate success when complete. The LED indicator will remain solid blue.



- Manual mode

The moment the plug is powered, the LED Indicator will be solid blue. The LED indicator will blink green after a moment. Choose Add Manually to begin the manual pairing process. The app will indicate the success when complete. The LED indicator will be solid blue.

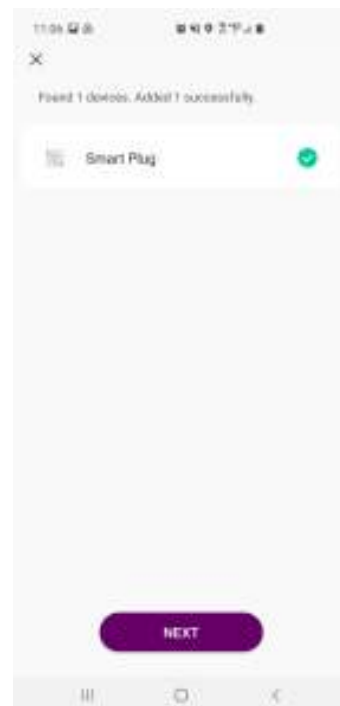

7.2. Removing Devices from Wi-Fi network

Select the Smart Plug that you want to delete on the APP. Tap the icon at the upper right corner. Then tap 'Remove Device' to remove the device from the APP and network.

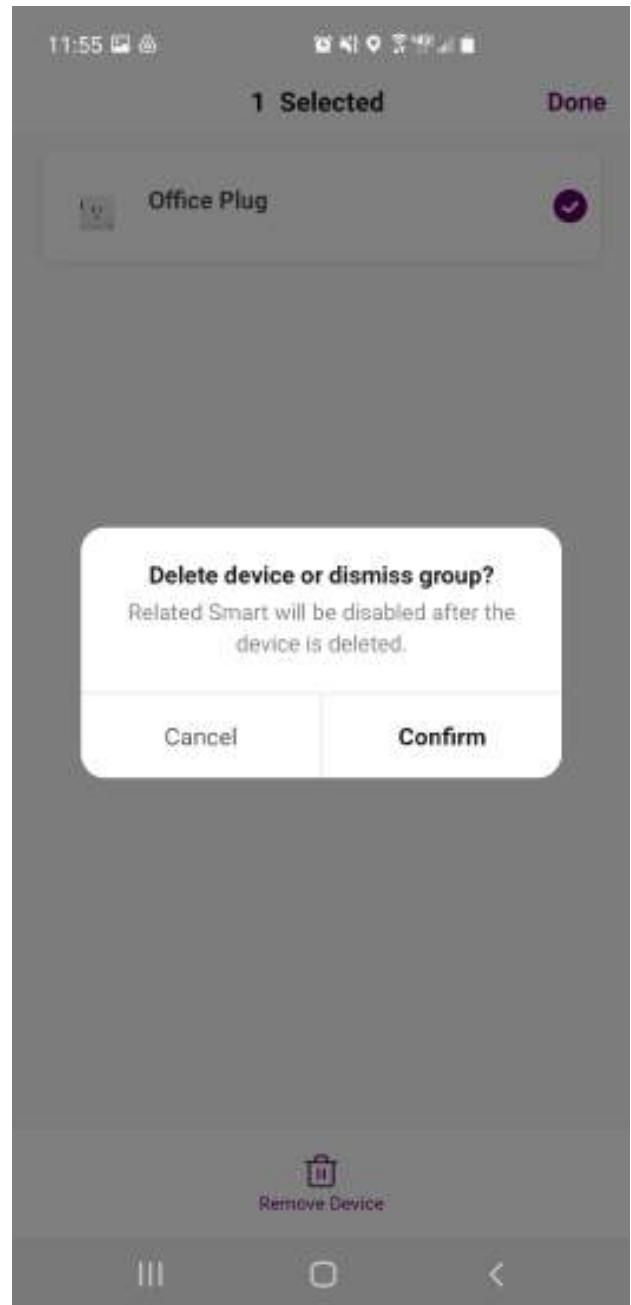
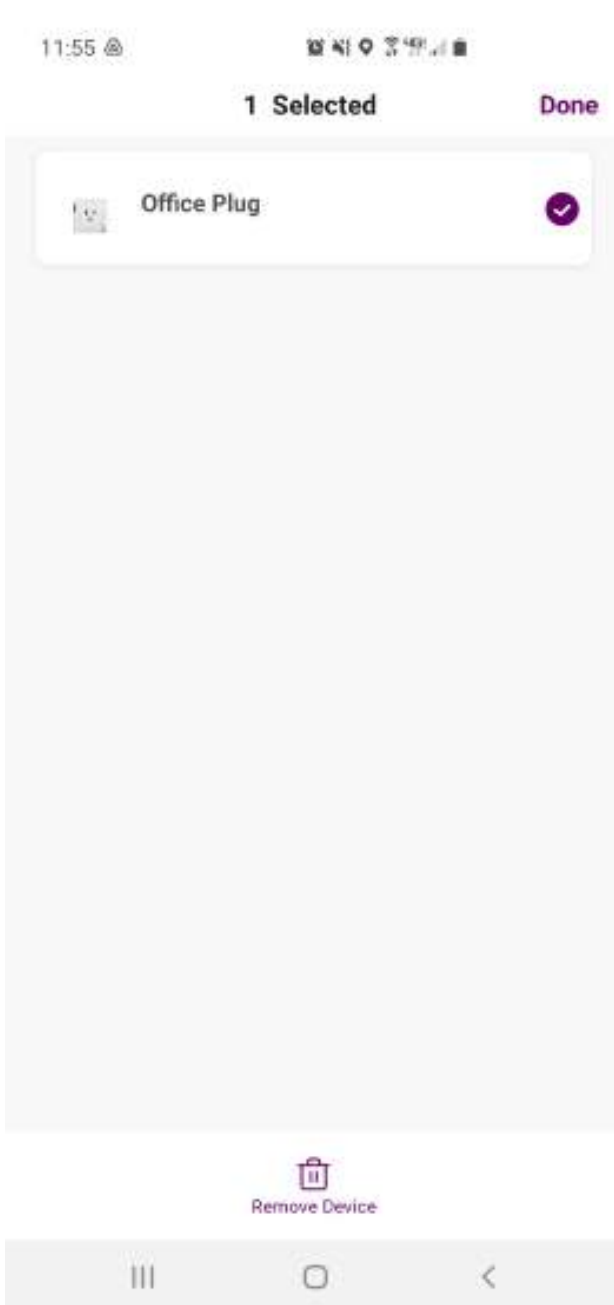

**NOTE:**

After the smart plug is added to a network successfully, you don't need to re-include it when it's powered again after a power loss. It will connect to the previous network automatically. During this process, it's LED indicator will blink slowly and later become solid.

8.RESET TO FACTORY DEFAULT

To reset the Smart Plug, press and hold the button for 5 seconds. The LED indicator will flash green.

Notes

- The Smart Plug should be used in dry places (Using in bathrooms etc. is not recommended.)
- Please use the Smart Plug in safe environment (Working power higher than 1800W or current higher than 15A are not recommended)

9.FCC NOTICE (FOR USA)

This device complies with part 15 of the FCC Rules. Operation is subject to the following two conditions:

- (1) this device may not cause harmful interference, and
- (2) This device must accept any interference received, including interference that may cause undesired operation.

The manufacturer is not responsible for any radio or tv interference caused by unauthorized modifications or change to this equipment. Such modifications or change could void the user's authority to operate the equipment.

This equipment has been tested and found to comply with the limits for a Class B digital device, pursuant to part 15 of the FCC Rules. These limits are designed to provide reasonable protection against harmful interference in a residential installation. This equipment generates, uses and can radiate radio frequency energy and, if not installed and used in accordance with the instructions, may cause harmful interference to radio communications. However, there is no guarantee that interference will not occur in a particular installation. If this equipment does cause harmful interference to radio or television reception, which can be determined by turning the equipment off and on, the user is encouraged to try to correct the interference by one or more of the following measures:

- Reorient or relocate the receiving antenna.
- Increase the separation between the equipment and receiver.
- Connect the equipment into an outlet on a circuit different from that to which the receiver is connected.
- Consult the dealer or an experienced radio/TV technician for help.

10.PLUG OPERATION

- The app user interface provides an easy way to turn your device on/off. Simply tap the power indicator in the center of the screen to change device state. The icon will change color to indicate whether device is on or off.

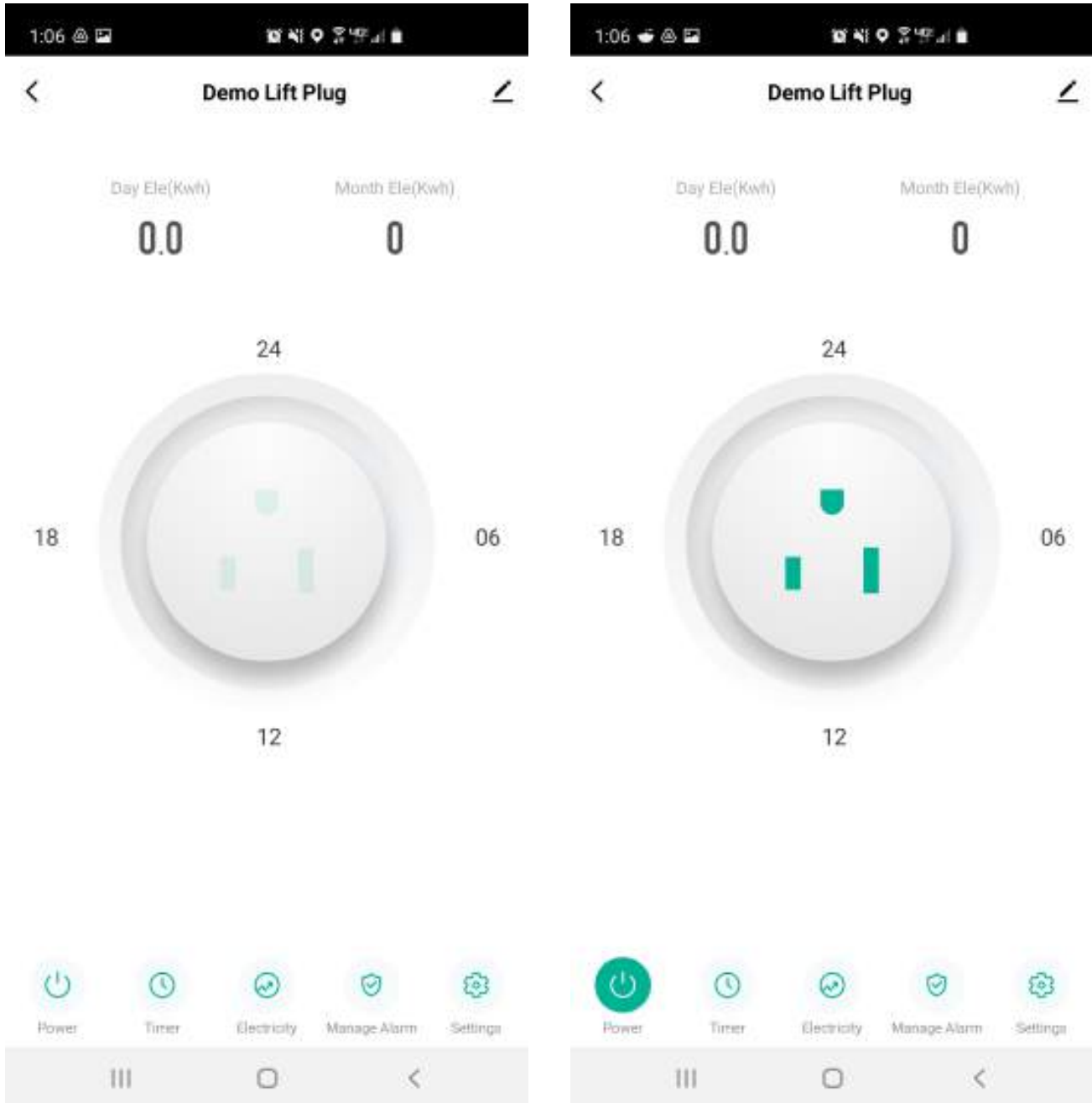

10.1 DEFAULT BEHAVIOR

- Through the settings panel, the default behavior can be set on the device. The internal relay can be set to default on or default off, depending on user needs. Defaulting to on can be beneficial in the event of a power outage, where the intended appliance needs to come back online as soon as possible. In this configuration, as soon as the plug receives power, the appliance will also receive power. This is true even if the network is down.

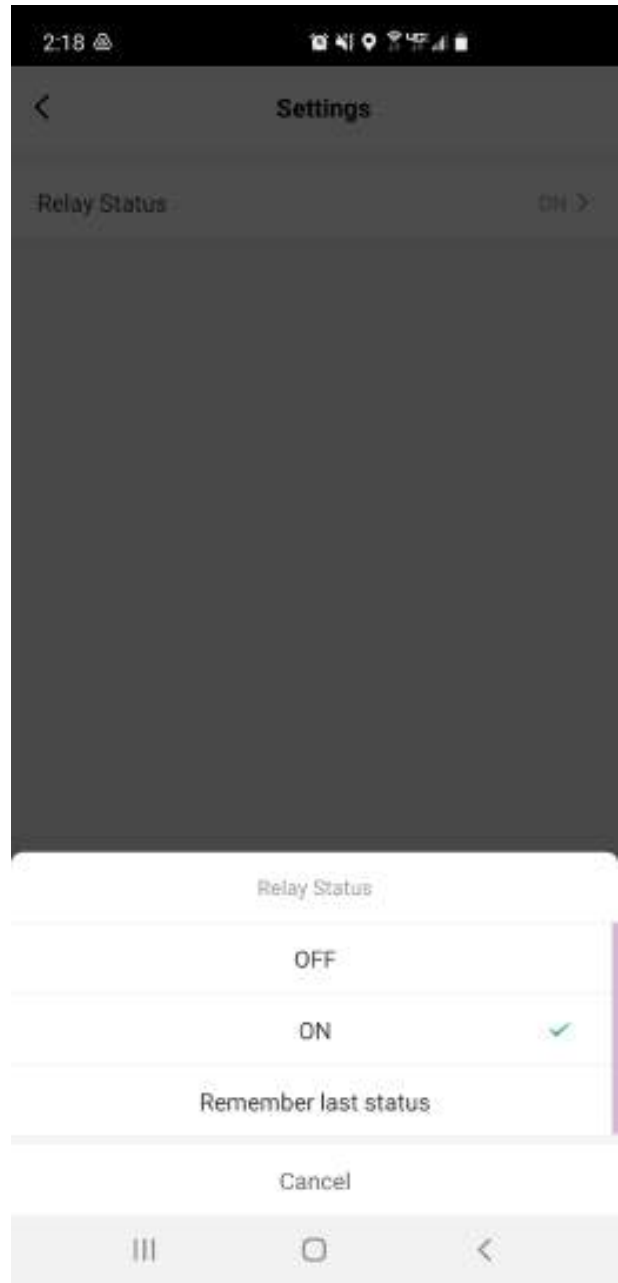
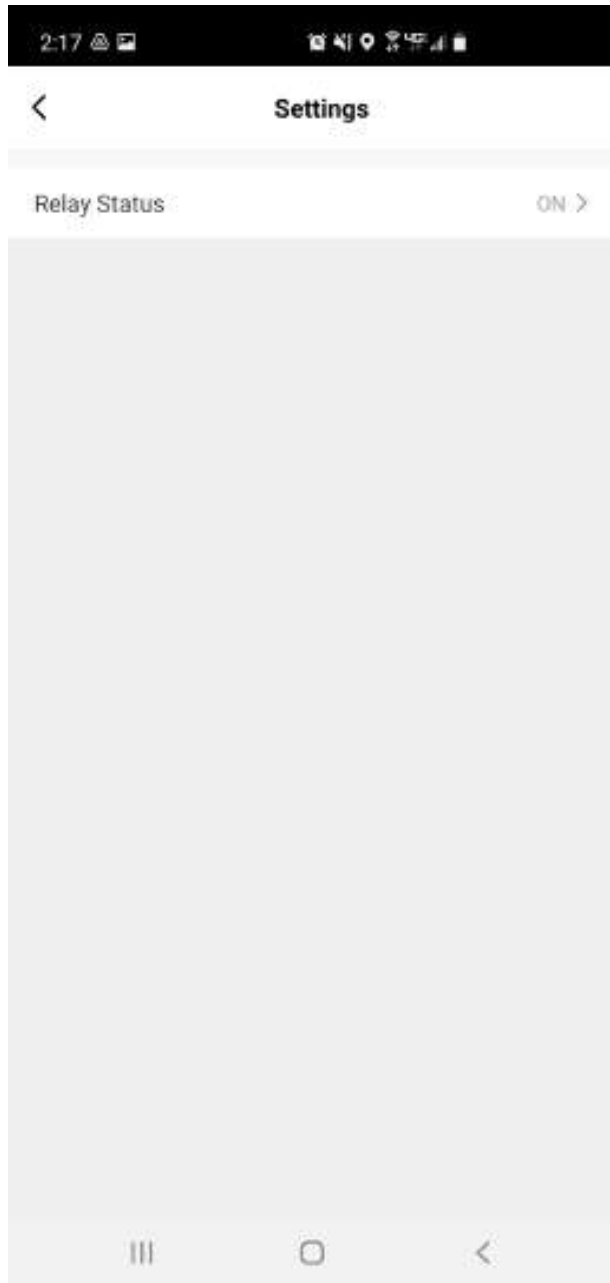

10.2 ALARM FUNCTION

- The SAT-0155 is equipped to support alarms on a 24 hour (military time) based clock. Users can set scheduled alarms and receive text alerts if the device does not detect usage within the time period specified.
- To set an alarm, tap "Manage Alarm" and tap "add."
- The start time must be earlier than the end time for the timer to set successfully.

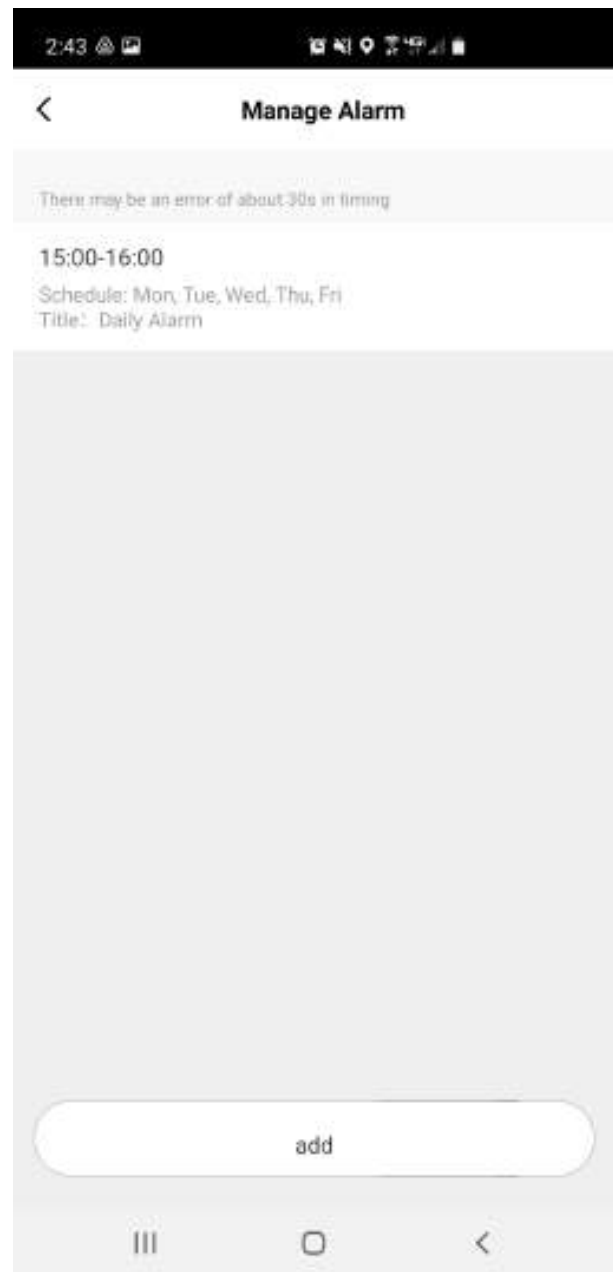

10.3 ENERGY MONITOR

- The SAT-0155 has built in circuitry to monitor energy usage. This information can be viewed by tapping "Electricity" in the user interface panel.

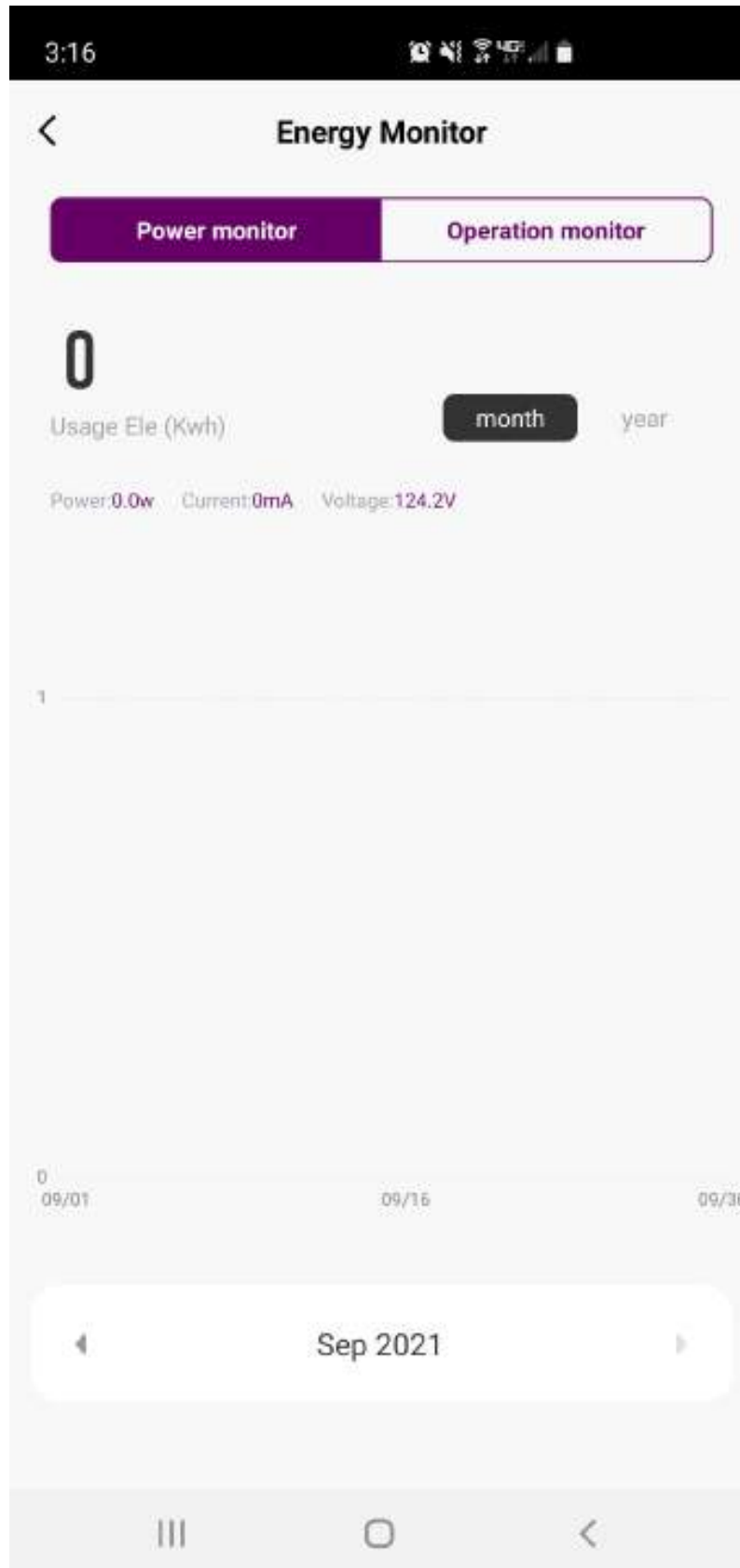

10.4 OPERATION MONITOR

- The SAT-0155 keeps a running log of activity, showing when the device has been turned on and off. This information can be viewed by tapping "Operation monitoring" inside the energy monitor panel.

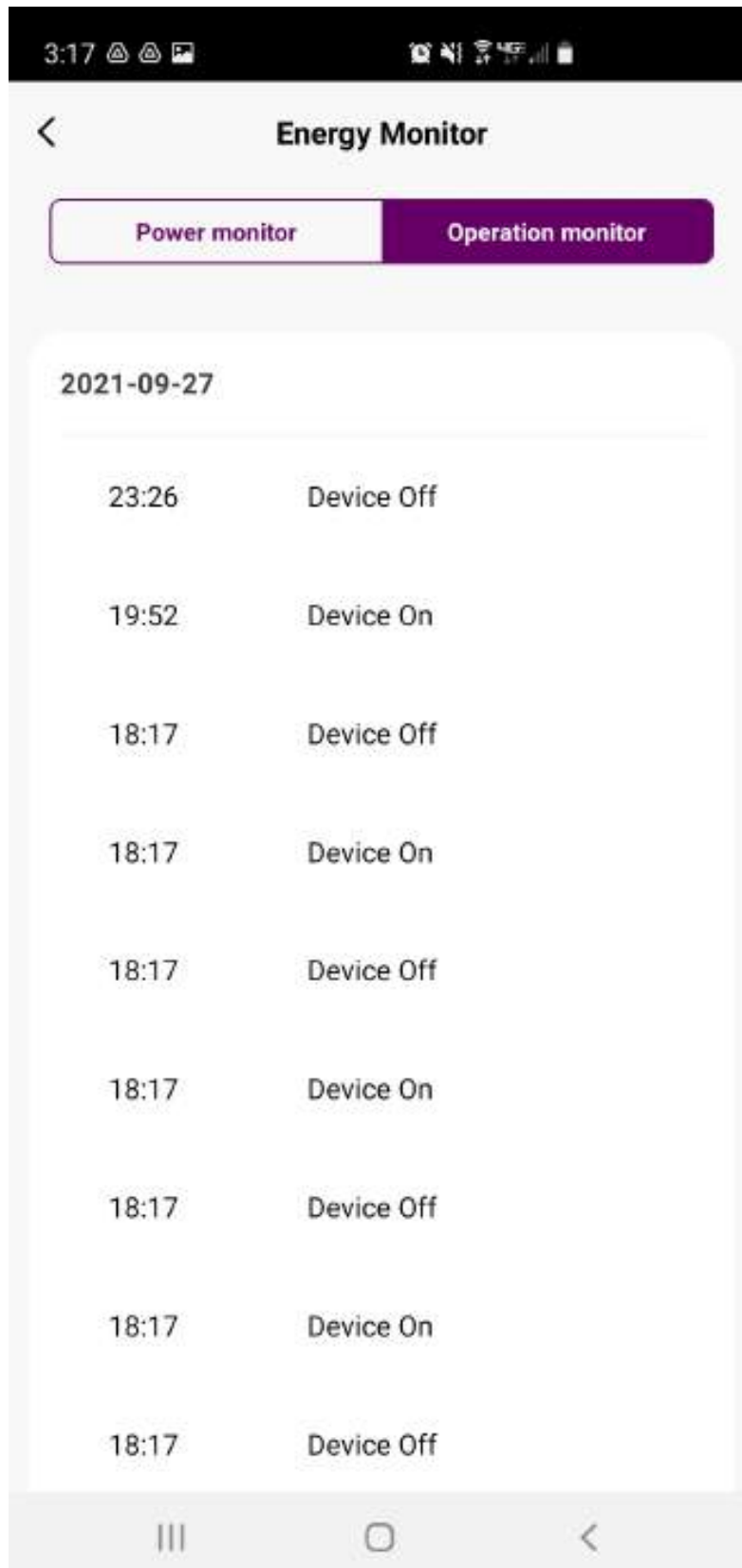

10.5 TIMERS

- By tapping "Timer," users can choose to operate the SAT-0155 based on 2 unique types of timer:
 1. **Countdown:** Device status will change based on current state at the end of allotted time. At the end of the countdown, the device will turn off if it is on or on if it is off.
 2. **Circulate:** Creates a running timer with scheduling features. Users can set the time window for operation, which days of the week should implement the timer, and how long the device should be on or off during the set time window.